



IMPORTANT



Be Sure
to Read this
Manual
Before Use



UNIS TECHNOLOGY

Operation Manual

WE ARE HERE TO ASSIST For parts and service



Have Questions? Contact us!

UNIS SERVICE CENTER
Tel: 972-241-4263
Email: service@unispartsandservice.com

When contacting Service, you will need the following information
and the name of your authorized distributor.

Suitable for Indoor Use Only	
NAME: Disc it for Tickets (65") GMP	MAX POWER: 400W
MODEL: C-575	MIN POWER: 300W
VOLTAGE: AC220V-240V~	FREQUENCY: 50/60Hz
S/N:	DATE:
Guangdong UNIS Technology Co.,Ltd.	

Suitable for Indoor Use Only	
NAME: Disc it for Tickets (65") GMP	MAX POWER: 400W
MODEL: C-575	MIN POWER: 300W
VOLTAGE: AC 110V ~	FREQUENCY: 50/60Hz
S/N:	DATE:
Guangdong UNIS Technology Co.,Ltd.	

CONTENT

IMPORTANT SAFETY INSTRUCTIONS.....3

1. SPECIFICATIONS..... 5

2. CONTENTS OF THE ACCESSORY KIT..... 7

3. PART NAME..... 8

4. SET UP & INSTALLATION..... 9

5. HOW TO PLAY..... 19

6. GAME OPTION..... 20

7. TROUBLESHOOTING..... 23

8. MAINTENANCE & INSPECTION..... 26

9. OVERALL CONSTRUCTION..... 34

10. WIRING DIAGRAM..... 54

Thank you for purchasing **Disc it for Tickets GMP** . We hope you enjoy the product.

This manual contains valuable information about how to operate and maintain your game machine properly and safely. It is intended for the owner and/or personnel in charge of product operation. Carefully read and understand the instructions.

If you need any help during installation and setup please utilize this manual and troubleshooting guide. If the product fails to function properly, *non-technical personnel should under no circumstance attempt to service the machine*. Contact your distributor or manufacturer for help.

Before use, please read **IMPORTANT SAFETY INSTRUCTIONS**.

IMPORTANT SAFETY INSTRUCTIONS

To ensure the safe usage of this product, carefully read and understand these instructions before operating your game.

Save these instructions for future reference.

Use this product only as described in this manual. Other uses not recommended may cause fire, electric shock or personal injury. Unplug the game from the outlet when not in use, when moving from one location to another, and before cleaning/servicing.

Explanations which require special attention are indicated by signs of warning. Depending on the potential hazardous degree, the terms: **NOTE**, **NOTICE**, and **WARNING** are used.

NOTE: A NOTE indicates useful hints or information about product usage.

NOTICE: A NOTICE indicates potential damage to product and how to avoid the problem.

WARNING: A WARNING indicates a potential for product damage or serious personal injury.

It is important to understand the meaning of the following HAZARD SIGNS before continuing:

High Voltage and Shock Hazard:

High voltage can cause electric shock.
Turn off/unplug power before servicing.



High Temperature Hazard:

This part may cause scalding.
Do not touch. Surface may be hot.



No Touching Hazard:

This part may be hot or can cause electric shock.
Do not touch.



Use the following safety guidelines to help ensure your own personal safety and to help protect your equipment and surrounding environment from potential damage.

⚠️ This product is an indoor game machine. Do not install outdoors.

Avoid installing in the following places to prevent fire, electric shock, injury and/or machine malfunctioning:

- Places subject to rain/moisture, or places subject to high humidity.
- Places subject to direct sunlight, or places subject to extremely hot or cold temperatures to ensure that it is used within the specified operating range.
- Places where inflammable gas may be present or in the vicinity of highly inflammable/volatile chemicals or items that can easily catch fire.
- On unstable or sloped surfaces. The machine may topple or cause unforeseen accidents.
- Vicinity of fire exits, fire extinguishers etc that may block/prevent safety measures.

IMPORTANT NOTE:

ALL REPAIRS MUST BE DONE TO ORIGINAL MANUFACTURER SPECIFICATIONS. FAILURE TO DO SO VOID ALL WARRANTIES AND OPERATOR ASSUMES ALL RISKS.

Note: The contents of this manual may be updated without notice.

1. SPECIFICATIONS

Rated power supply: AC110V 50/60Hz; AC220V-240V 50/60Hz

Min. Power consumption: 300W

Max. Power consumption: 400W

Dimension: W39.46×D102.44×H104.79in

W1002 ×D2602 ×H2664 mm

Weight: Approximately 771.61lb/350kg

Part No: D161

Model No: C-575

Part No:D161

 **NOTICE:** After turning off the game, please wait at least 1 minute before restarting again.

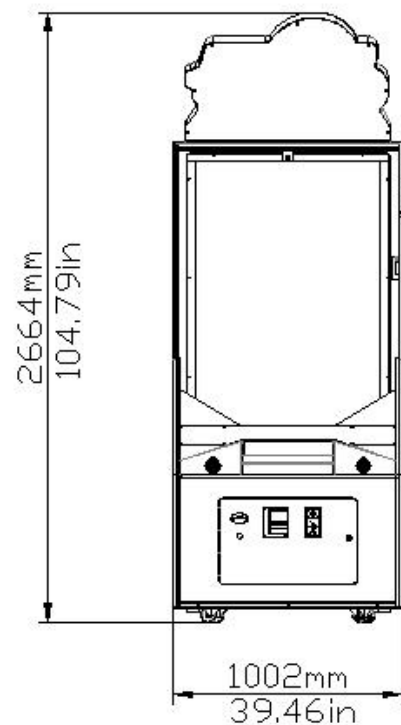
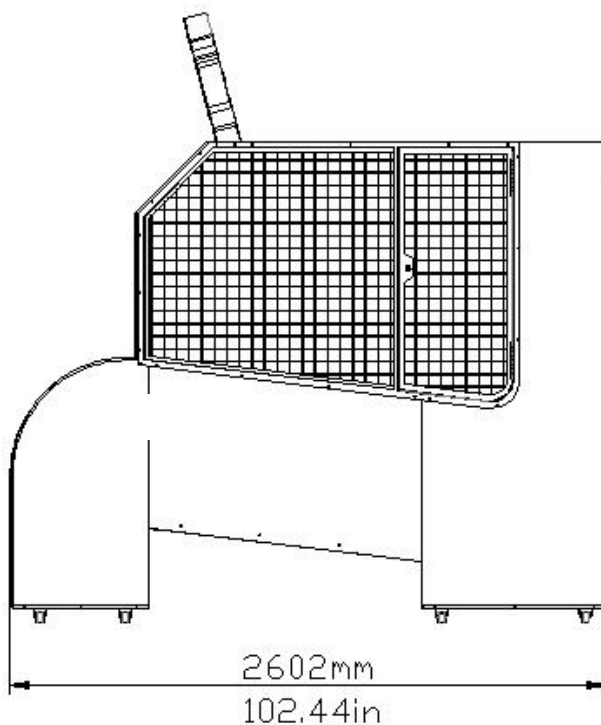

Note: Game specifications are subject to change without notice.

This machine will be divided into two parts during transportation.

Control panel: W39.46×D23.74×H45.54 in

W1002 ×D603 ×H1157 mm

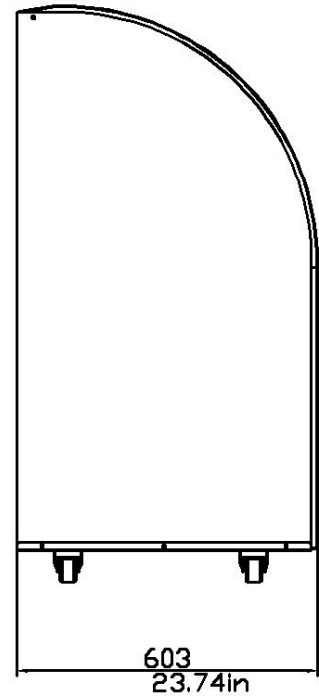
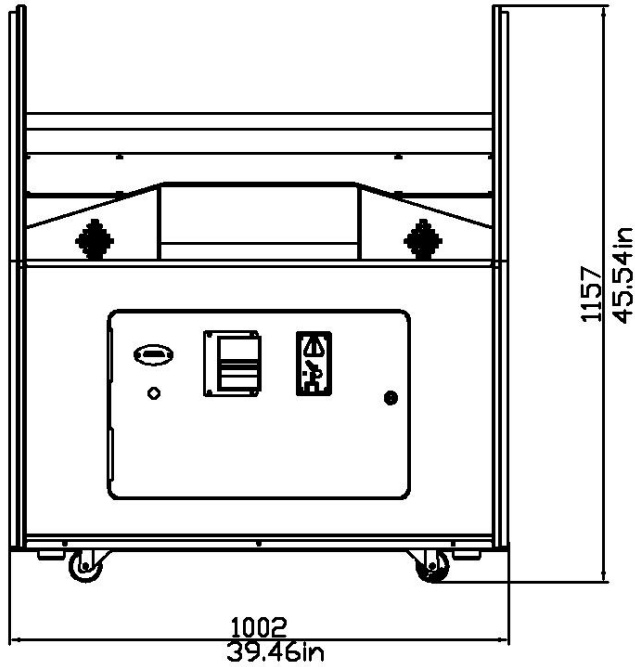

Back cabinet: W39.37×D31.50×H80.00 in

W1000 ×D800 ×H2030 mm

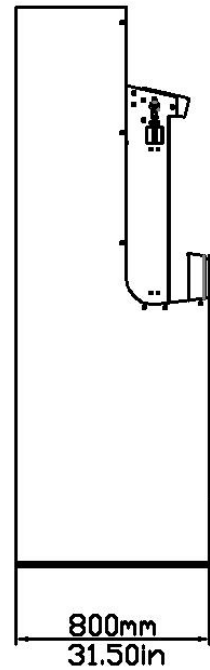
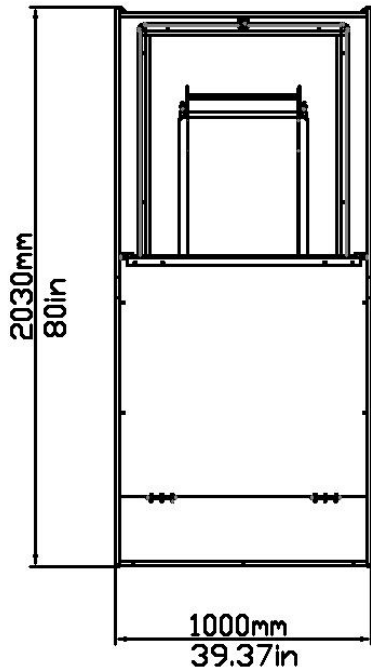

Note: Game specifications are subject to change without notice.

2. CONTENTS OF THE ACCESSORY KIT

Open the package and make sure all the items are included:

Following accessories

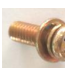
No.	Part No.	Code	Name	SPEC	Picture	Qty
1	D161-801-000	41001000012	Red disc	PVC	/	6
2	D161-411-000	41001000013	Blue disc	PVC	/	6
3	D161-412-000	25300171002	Key	171		2
4	D161-802-000	25300172002	Key	171B		1
5	D161-803-000	20101040005	Hexagon socket flat head screw	M4×12 Nickel plating		8
6	D161-312-000	26000040000A	5mm screw holder	Black		8
7	D161-106-000	26000052000	Washer	δ1		8
8	D161-111-000	20101040024	Cross recessed pan head screw	M4×12 Nickel plating		64
9	D161-313-000	20101040049	Cross recessed pan head screw	M4×25 Nickel plating		8
10	D161-315-000	20101020037	Cross recessed pan head screw set	M4×25 Color zinc		8
11	D161-309-000	20104020002	Cross recessed hexagon screw set	M6×16 Color zinc		20
12	D161-428-000	21901000030B	Fuse	Φ5×20mm T10A 250VAC (PSE UL)		1
13	D161-804-000	23301010020	Power cord	3×16AWG 1.8M		1
14	D161-801-000	41440000293	Manual	/		1
15	D161-433-000	21901000012	Fuse	Φ5×20mm T5A 250VAC		1

NOTE: Part models are subject to change without notice

3. PART NAME

Key Components



4. SET UP & INSTALLATION

⚠ NOTICE

We do not recommend using power tools as they may cause damage.

⚠ **This product is an indoor game machine. Do not install outdoors.**

- Refer to IMPORTANT SAFETY INSTRUCTIONS (Pg. 3) for places to avoid.
- Place the unit on a dry level surface.
- Ventilation openings in the back of the unit must not be obstructed by objects or by wall.

4.1 Transporting the Game

If you need to move the game, adjust the levelers back to an “un” position.

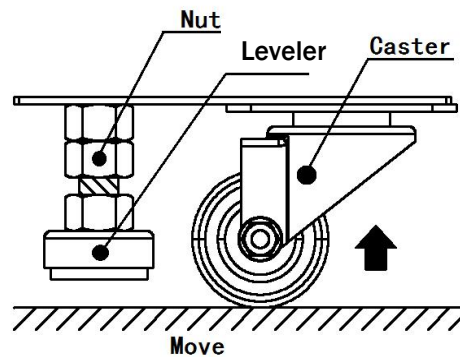
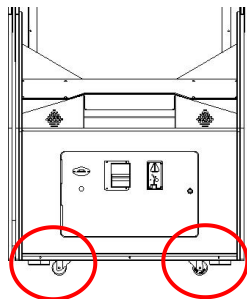

⚠ NOTICE

- Be careful not to damage the machine during transport.
- Always unplug the game before moving.
- Keep the machine in upright position during transport.
- For longer distance transport, package the game properly to prevent damages.

4.2 Level Adjustment

Install this game on a flat surface. If the game is installed on an unsuitable floor, it could cause game malfunction.

To secure the game, loosen the nut, utilize wrench to adjust the leveler down until it touches the floor, lifting the casters off the ground by 0.2 in/5mm. Repeat the same for all levelers.

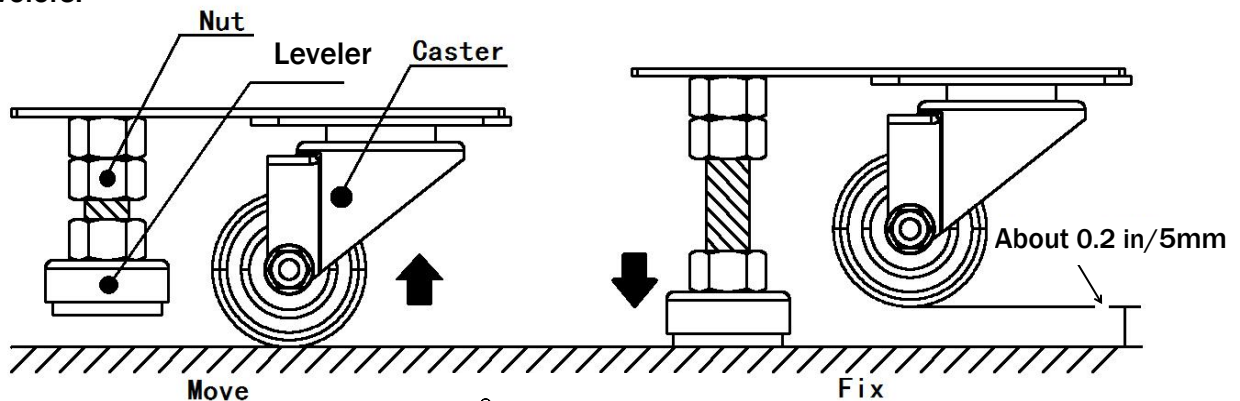

⚠ NOTICE

Make sure the machine is level.

4.3 Play Zone

This machine requires space for playing and for maintenance as shown below.

Leave space around the game upon installation:

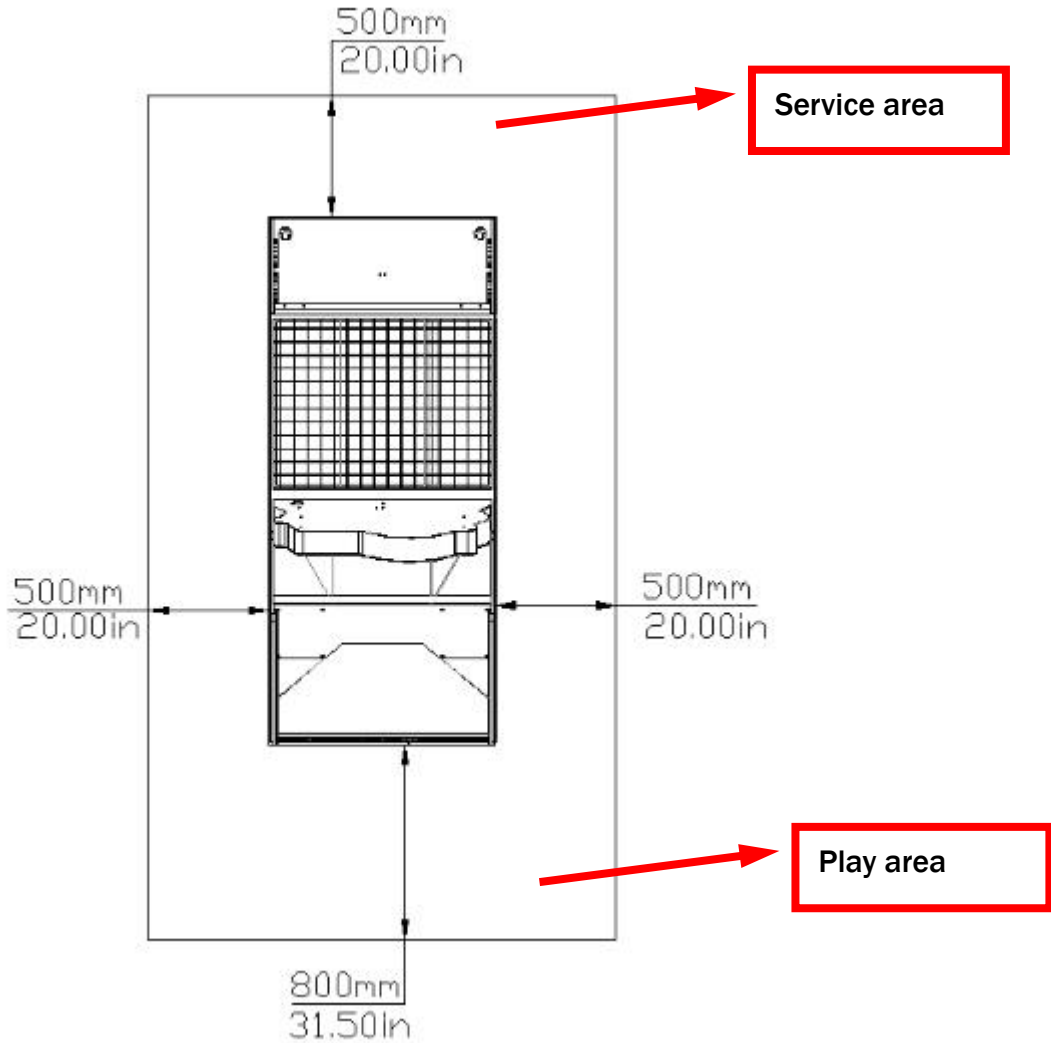

Service area: 20 in



NOTICE

Your unit must be leveled to operate properly.

Before processing with assembly assure you have the following tools.

No.	Name	Picture
1	Phillips screwdriver	
2	Allen wrench	

4.4 Machine Installation

Step 1 Turn the Bottom lane assembly down indicated by arrow. Utilize Phillips screwdriver to tighten 8 screw sets to fix Bottom lane assembly to Control panel.

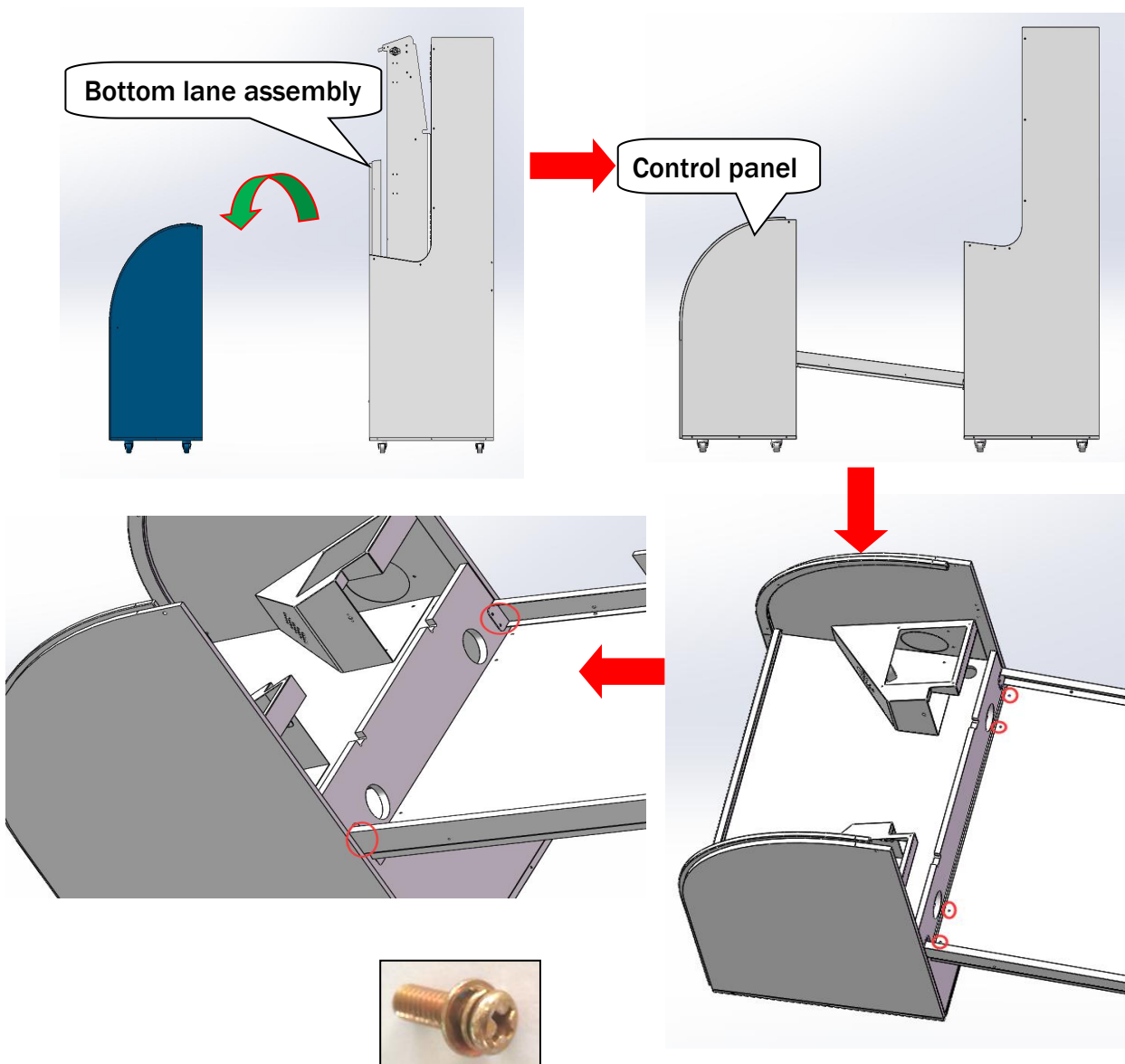

Name	Cross recessed pan head screw set
Spec.	M4X25
Qty	8

Step 2 Utilize Phillips screwdriver to tighten 4 screw sets to fix Bottom lane assembly to Main cabinet.

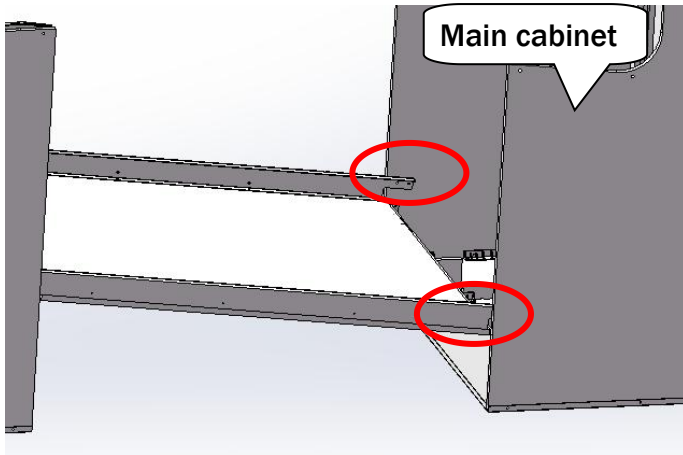

Name	Cross recessed pan head screw
Spec.	M4X12
Qty	4



Step 3 Utilize Phillips screwdriver to loosen screws indicated and turn Upper lane assembly down. Place front side of Upper lane assembly to the slot on the Control panel.

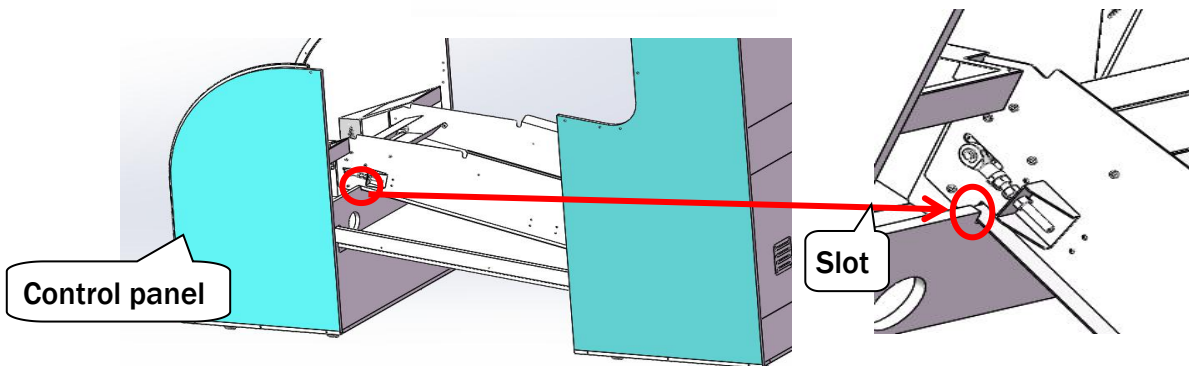
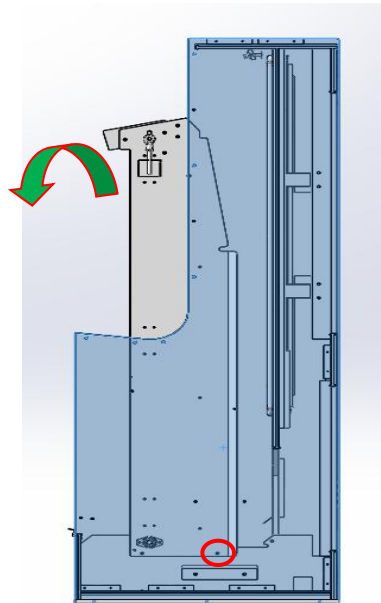

Step 4 Place axle on the slot as shown below.

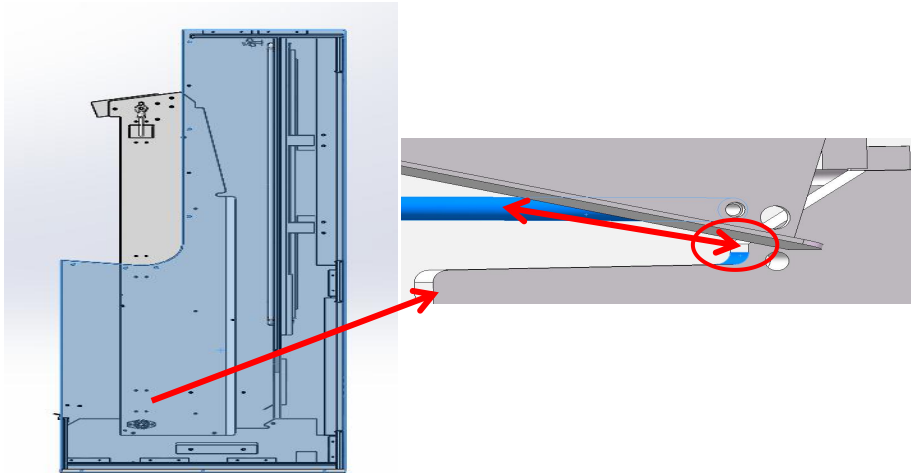

Step 5 Utilize Phillips screwdriver to tighten 2 screw sets to fix Upper lane assembly to Main cabinet.

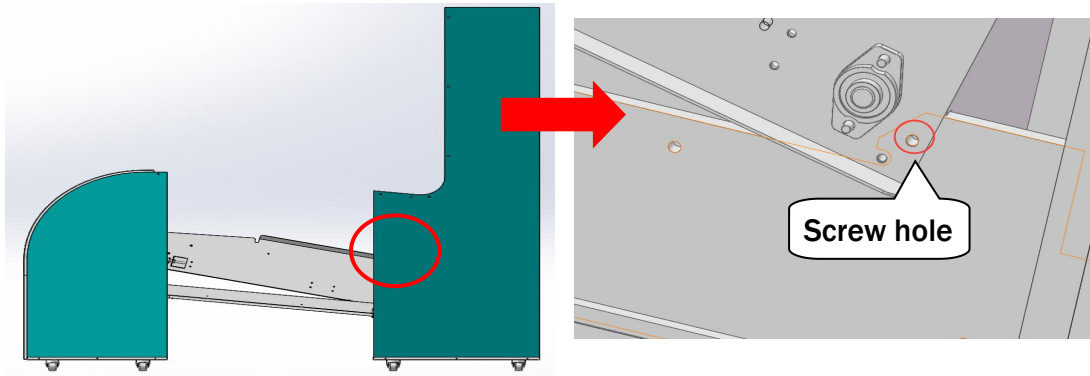

Name	Cross recessed pan head screw set
Spec.	M6X16
Qty	2



Step 6 Utilize Phillips screwdriver to tighten 5 screws to fix Middle side plate to Upper lane assembly and Main cabinet. The same installation on the other side.

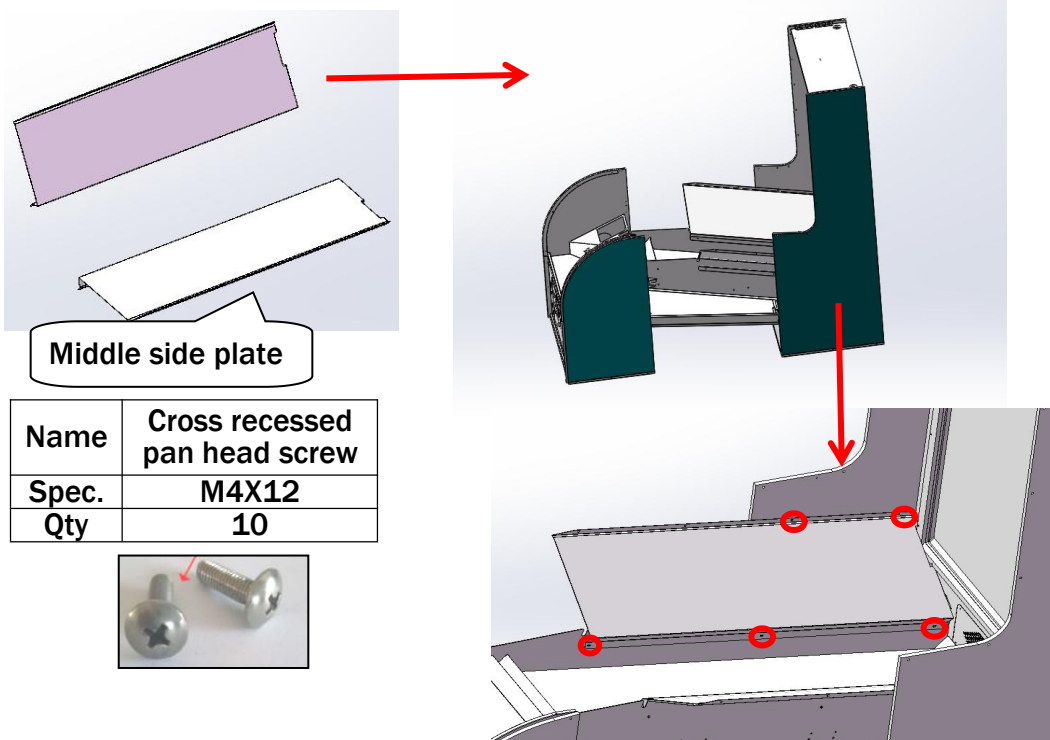

Name	Cross recessed pan head screw
Spec.	M4X12
Qty	10



Step 7 Utilize Phillips screwdriver to tighten 3 screws to fix Side plate to Bottom lane assembly. Plug the connector. The same installation on the other side.

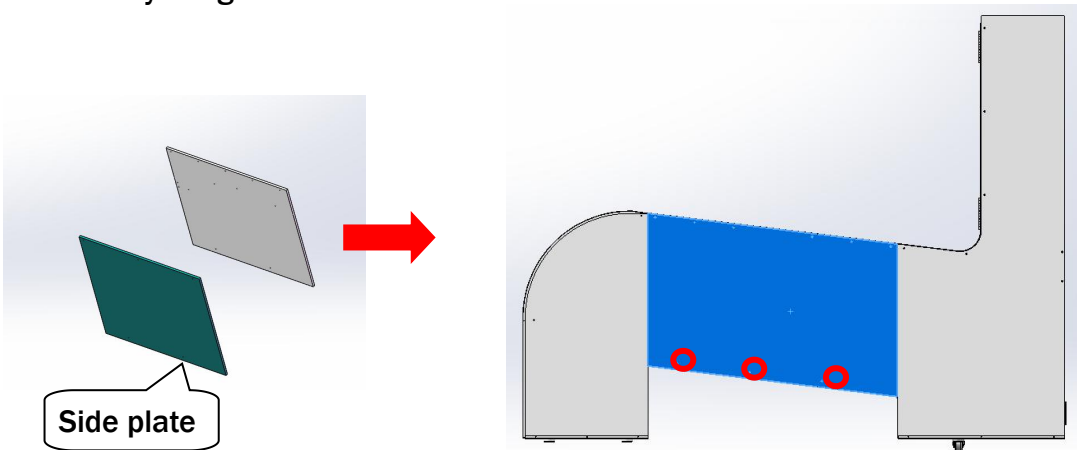

Name	Cross recessed pan head screw
Spec.	M4X25
Qty	6



Step 8 Utilize Phillips screwdriver to tighten 2 screws to fix Side plate to Middle side plate. The same installation on the other side.



Name	Cross recessed pan head screw
Spec.	M4X12
Qty	4

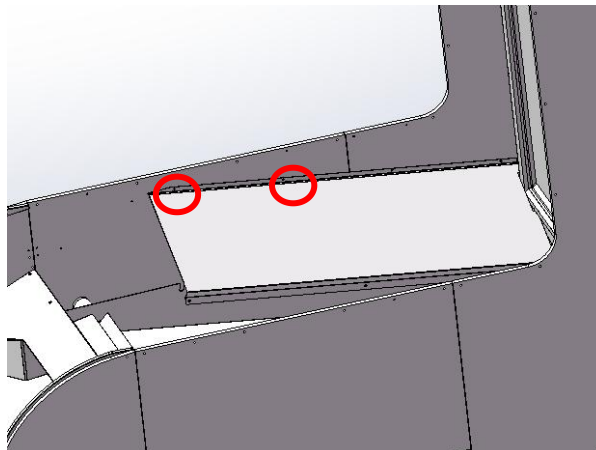

Step 9 Place Joint pin on the Side plate and Control panel. Utilize Phillips screwdriver to tighten 4 screws. The same installation on the other side.

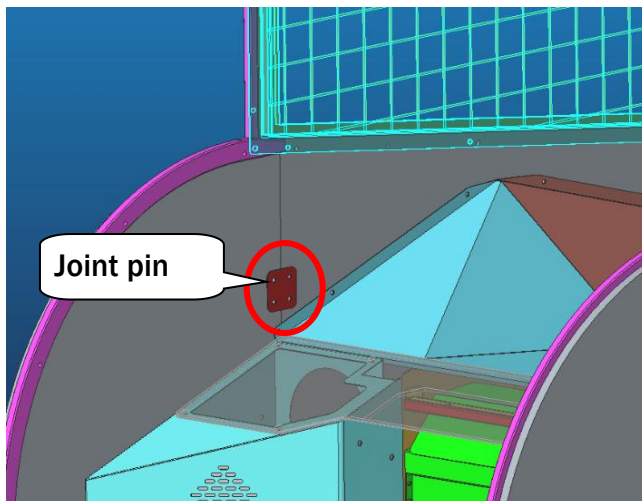

Name	Cross recessed pan head screw
Spec.	M4X12
Qty	8

Step 10 Place Front cover on the Upper lane assembly and utilize Phillips screwdriver to tighten 6 screws.

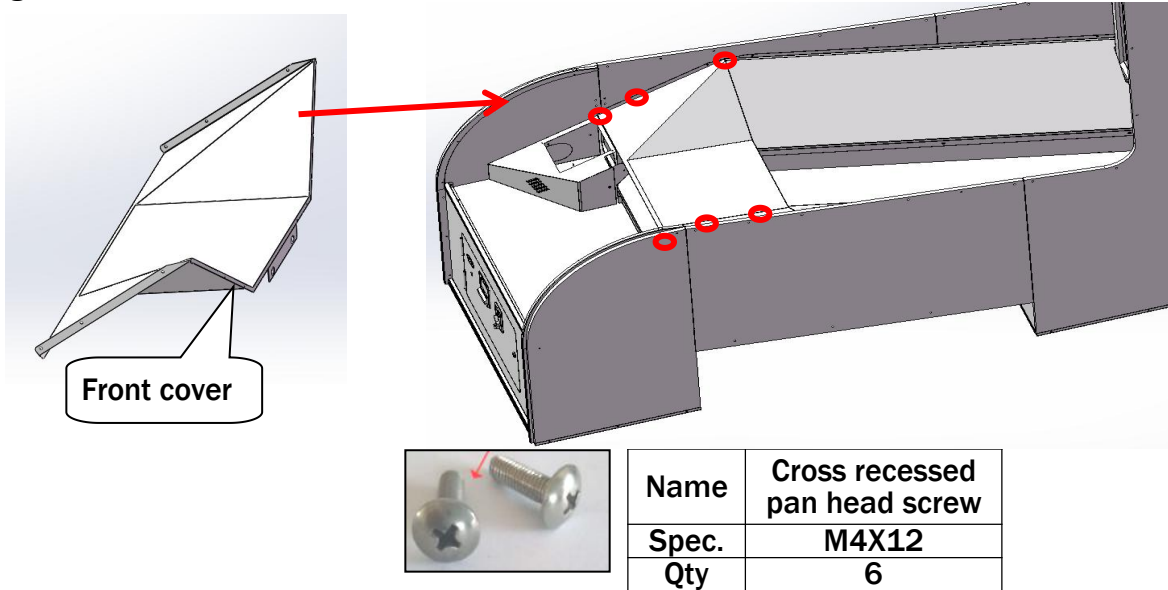

Step 11 Place Scoreboard decal on the right side of Control panel as shown below, follow **Step 12** to place the Control panel plastic to cover it.

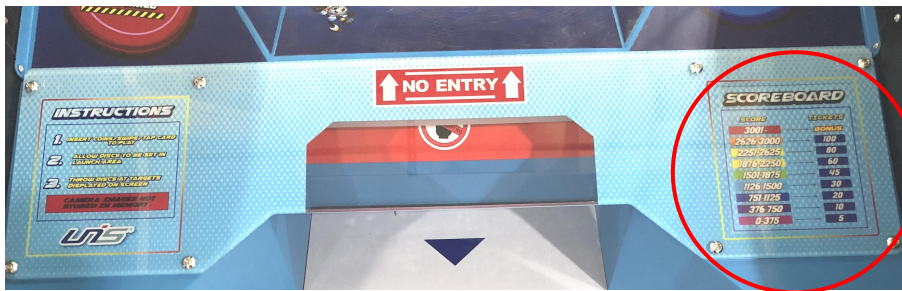

Step 12 Place Control panel plastic on the Control panel. Utilize Allen wrench to tighten 8 screws, washers and screw holders to fix Control panel plastic to Control panel.

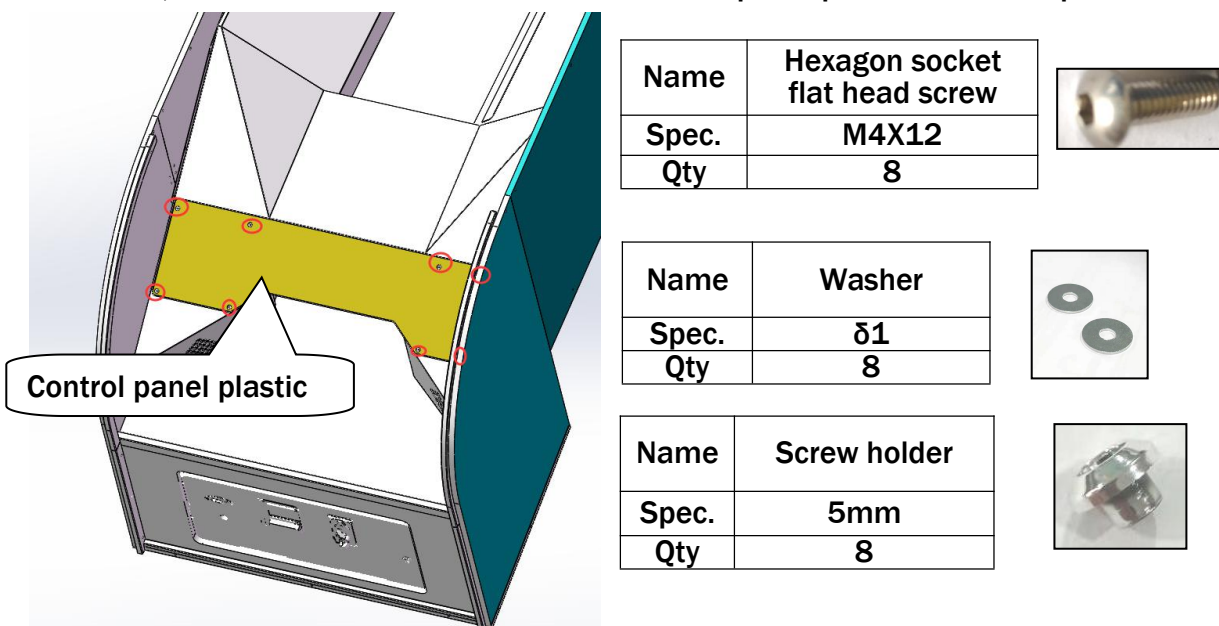

Step 13 Utilize Phillips screwdriver to tighten 10 screws to fix Net to the Main cabinet. The same installation on the other side.

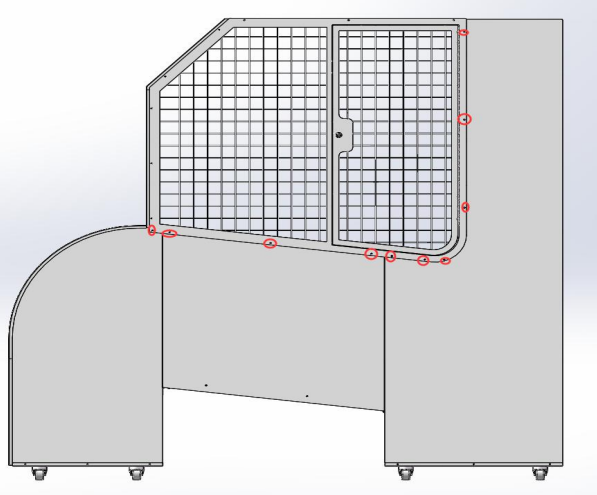
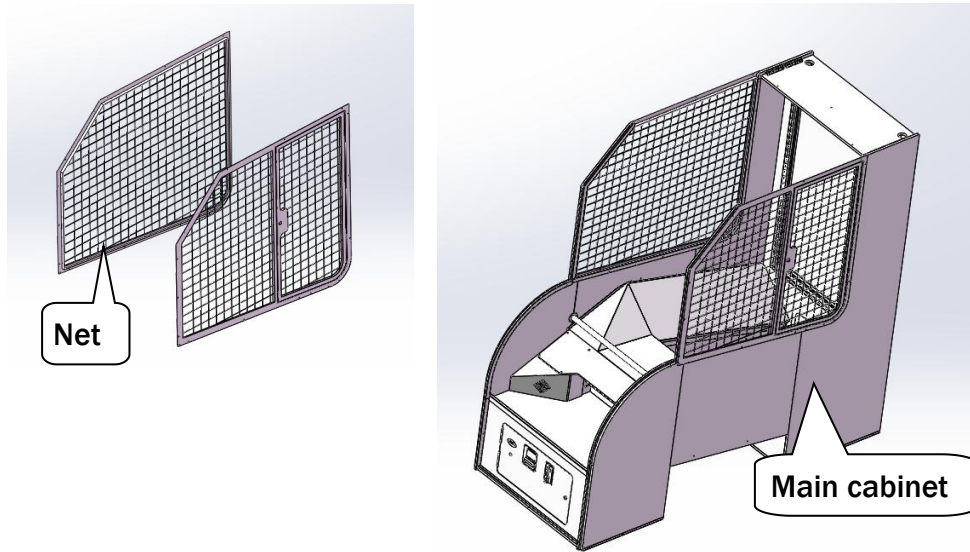

Name	Cross recessed pan head screw
Spec.	M4X12
Qty	20

Step 14 Utilize Phillips screwdriver to tighten 4 screws to Marquee fixed plate to Net.

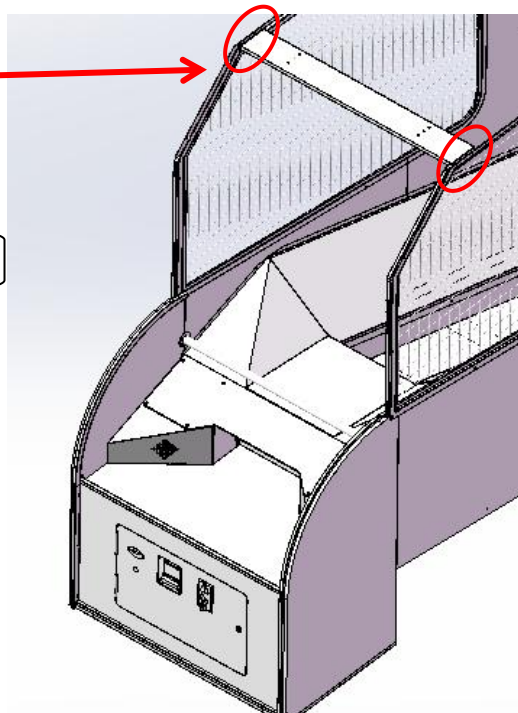
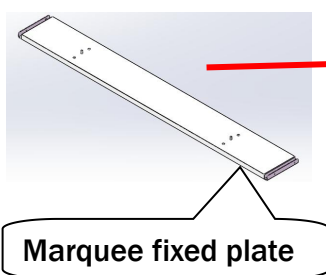

Name	Cross recessed pan head screw
Spec.	M4X12
Qty	4

Step 15 Utilize Phillips screwdriver to tighten 2 screws to Top Net to the Main cabinet.

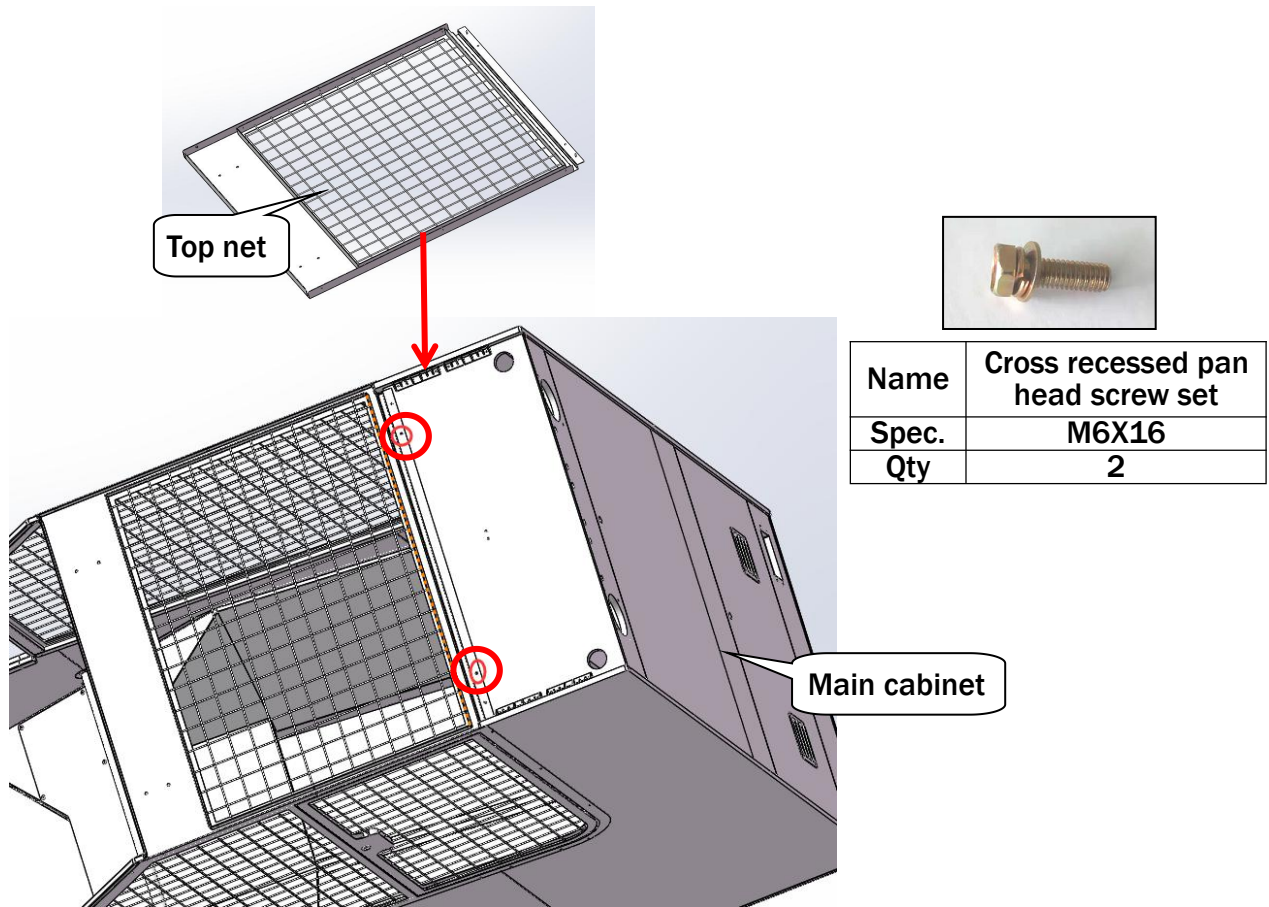

Step 16 Utilize Phillips screwdriver to tighten 11 screws to fix Top Net to 2 Side nets and Marquee fixed plate.

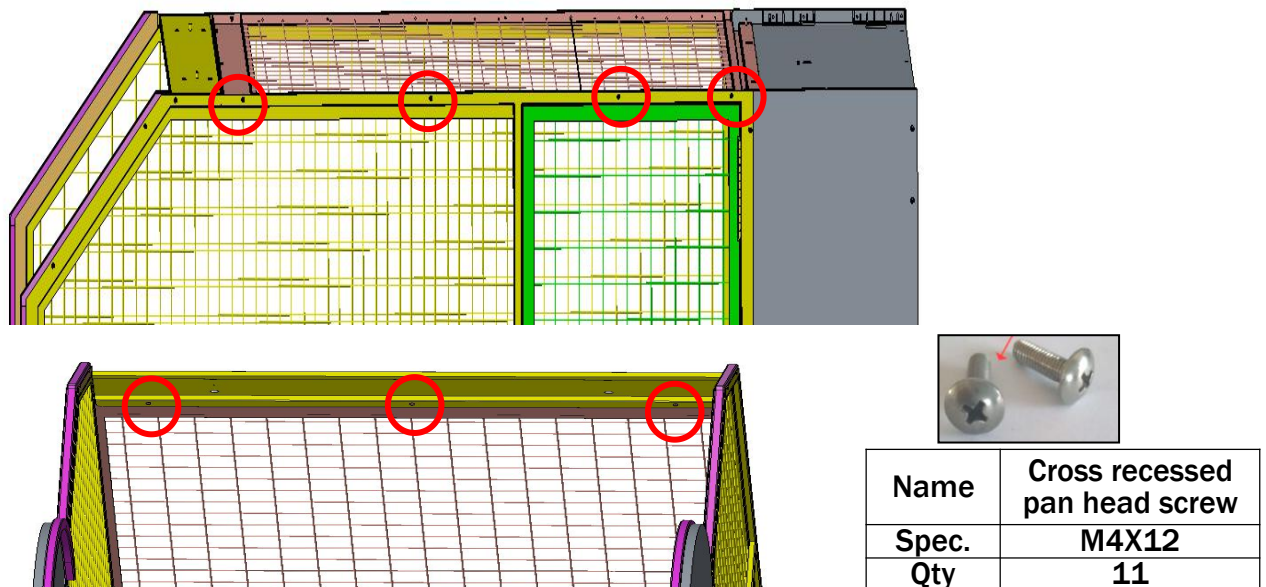

Step 17 Utilize Phillips screwdriver to tighten 4 screws to Single marquee to Marquee fixed plate.

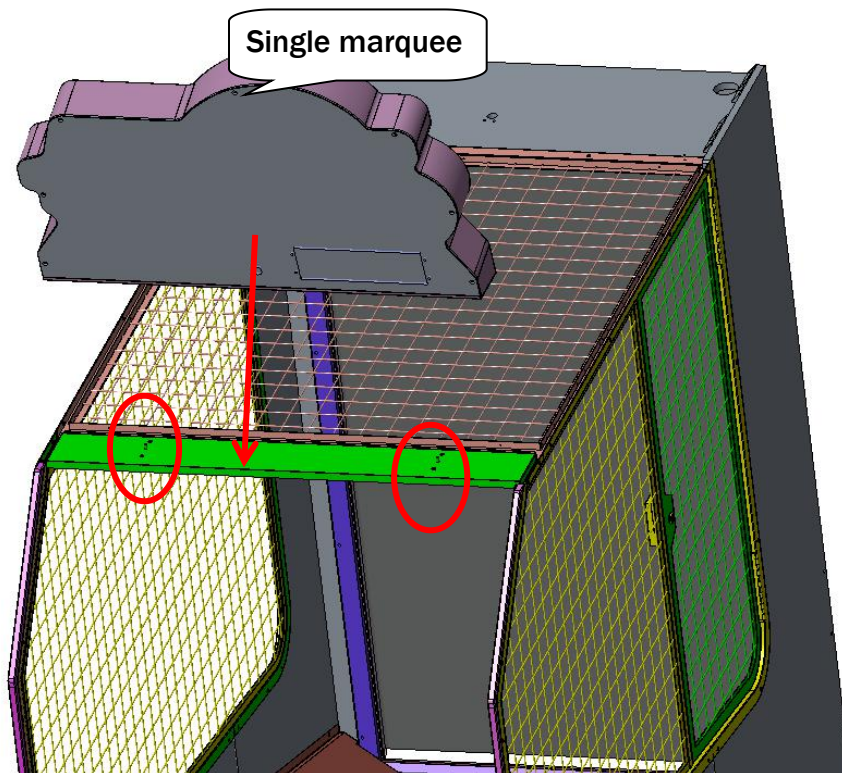

Name	Cross recessed pan head screw set
Spec.	M6X16
Qty	4



Finish!

5. HOW TO PLAY

5.1 Insert coins to play.

5.2 Select mode.

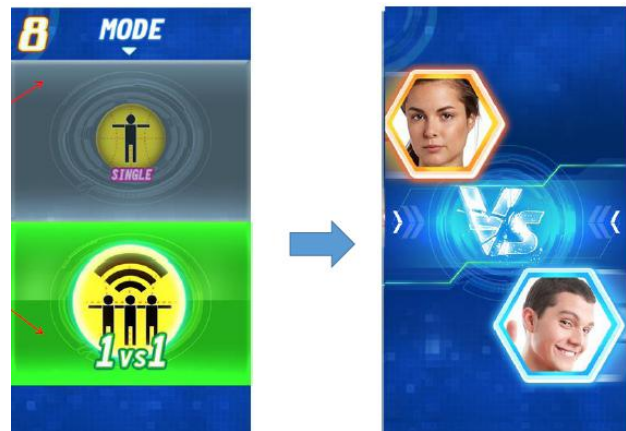

5.3 Throw the disc to hit the score board, sight, diamond, missile to get score. Reach the required score in limited time can enter next round.



5.4 Ranking List shows the player's ranking, challenge round and score.

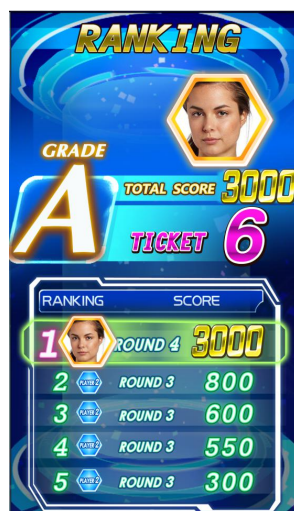

6. GAME OPTION

6.1 Adjustment button instruction

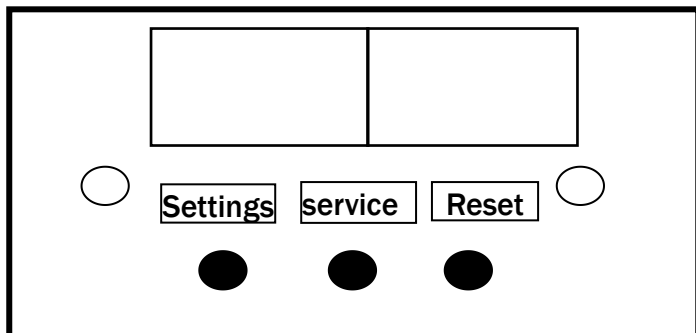

Open the coin door and there is a meter panel. Press Settings button to enter the setting menu.

6.2 Setting menu

6.2.1 Main menu

Basic Setting
Customized Setting
Input Test
Output Test
Game Reset
Date/Time Setting
Language/语言
Bookkeeping
Daily Record
About This Game
Back To Game

6.2.2 Basic Setting

Free Play	OFF/ON
Tickets Out	OFF/ON
Demo Music	OFF/ON
Memory Save	OFF/ON
Volume	0-10
Payout ON/OFF	OFF/ON
Payout	0_10
Game Time	60_90_120_150_180
Coins Per Game	1_200
Pay Mode	Coins_Card_Insert Coins/Swipe Card
Ticket Memory	Ticket Memory_Call Attendant
Bonus	200_5000
Back & Save	
Back	

6.2.3 Customized Setting

Single Game Fail Continue	OFF_ON
Back&Save	
Back	

6.2.4 Input Test

1P Coin	OFF_ON
Back	

6.2.5 Output Test

Screen Red Light
Screen Green Light
Screen Blue Light
Left Side Red Light
Left Side Green Light
Left Side Blue Light
Right Side Red Light
Right Side Green Light
Right Side Blue Light

Control Panel Red Light
Control Panel Green Light
Control Panel Blue Light
Out of Ticket Light
Coin Counter Drive
Ticker Counter Drive
Conveyor motor
Lock Coin
Out One Ticket
Back

6.2.6 Game Reset

Factory Restore	CANCEL_CLEAR
Reset Basic Setting	CANCEL_RESET
Reset Customized Setting	CANCEL_RESET
Clear All Records	CANCEL_CLEAR
Clear Owed Ticket	CANCEL_CLEAR
Clear Unused Coin	CANCEL_CLEAR
Back	

6.2.7 Date/Time Setting

Year
Month
Day
Hour(24)
Minute
Second
Back&Save
Back

6.2.8 Bookkeeping

Player	Coins	Payout Tickets	Pay out
NON RESETTABLE POINTS			
Back			

6.2.9 Daily Record

Date	Weekday	Run Time	Coins	Payout Tickets	Pay out
Clear Back					

6.2.10 About This Game

Press the Test Button to Go Back
CPU
Main board
HDD
RAM
Monitor
Monitor Resolution
Version

7. TROUBLESHOOTING



7.1 Common Problem

Please confirm that all connectors fit tightly.

Symptom	Possible Cause	Recommended action
Game will not start	Frame assembly connector is loose.	Check connector.
	Frame assembly fault	Contact with UNIS Service.
Power off	Circuit protector make power SW in off state.	Turn on power SW again. If appeared again and again, machine has anomaly. Please contact with UNIS Service.
Card reader not working	The connector is loose.	Check connector.
	Card reader fault.	Check with card reader manufacturer.
No ticket dispensing	Out of ticket.	Add ticket and press reset button
	Ticket jamming.	Remove the jammed tickets and press reset button.
	The connector is loose.	Plug the connector tightly.
No sound	Low volume	Raise the volume.
	Connector loose.	Check connector.
	Speaker fault.	Check speaker.
	POT installation error.	Install POT correctly.
	POT fault.	Change POT.
	Audio cable problem.	Reconnect the audio cable or change it.
	PC crash.	Restart or system recovery.
Driver problem	Restart the audio driver.	
Display black screen	Check connectors.	Plug in connector tightly
	Display fault.	Utilize another source such as a PC to verify if the display is operational.
	RAM is loose.	Remove and reinsert RAM.
Display blue screen	PC power cord is loose	Check PC power cord whether is loose.
	VGA signal cable is loose.	Check VGA cable
	PC video card is loose.	Reseat video card.
	“0X000000A” code appears. Conflict between computer drive and software.	Contact service

Note: After replacing component from PC (except for RAM), and replacing monitor, the game should be recovered again with the recovery stick attached to the machine.

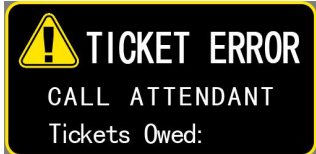
If you see following error signs showing on the display, please try the recommended action.

Display	Possible Cause	Recommended action
	The connection part of the IO board and PC are loose.	Check and reconnect the loose ports of the PC or IO board.
	Cable quality problem	Change the cable after checking the connection between IO board and PC.
	Cable became loose during transportation.	Check and reconnect the loose cables of the PC or IO board.
	IO board is faulty.	Reboot the game after checking connection and cable problem, if the problem remains unresolved, please call the service department for assistance.
	Out of ticket.	Refill ticket
	Loose connection of the ticket dispenser's cables.	Check and reconnect the loose cables to the ticket dispenser.
	Ticket dispenser is faulty.	Change the ticket dispenser.
	Ticket jam.	Remove jammed tickets.
	Conveyor or sending area jam	Remove jammed object.
	Conveyor motor is faulty.	Change the motor.

7.2 System Recovery Operation **(NOTE: Do not disconnect power during this process.)**

1. Turn off the game. Remove the recovery stick from the machine. (Note: This process may take up to 60 minutes) Insert the recovery stick into the port at the back of the computer.
2. Restart PC to enter the system recovery screen as shown.

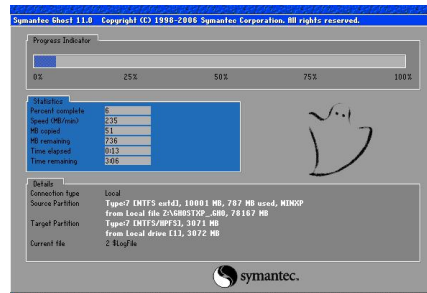

3. The game will automatically start recovery.
4. Once system recovery is partially finished (as shown below), and the ICON appears, remove the recovery stick from the computer. The game will continue the install process.

OK to remove the recovery stick.



5. Assure that the recovery stick has been properly secured for future use.



WARNING: The recovery stick should only be used to fix software errors. Using it for other purposes may cause unexpected results and damages.

8. MAINTENANCE & INSPECTION

8.1 Safety Check

Check the points listed before operating the machine. These checks are necessary for safe machine operation:

1. Test game before operation each day.
2. Conduct monthly routine checks of game components to ensure good working condition.
3. Check the machine regularly for dust and clean when necessary.

Note: Parts and components require preventative maintenance to maintain proper operation.

8.2 Handling Precautions

When installing or inspecting the machine, be very careful and pay attention to ensure that the player can enjoy the game safely.

Inappropriate handling running counter to the cautionary matters can cause personal injury or damage to the machine.



NOTICE

We do not recommend using power tools as they may cause damage.

8.3 Convey Assembly Disassembly Instruction

Before processing with assembly assure you have the following tools.

No.	Name	Picture
1	Phillips screwdriver	

Step 1 Power off the machine. Utilize Phillips screwdriver to loosen 8 screws, washers and screw holders to remove Control panel plastic and Scoreboard decal as rectangle indicated.

Step 2 Utilize Phillips screwdriver to loosen 6 screws to remove Front cover as triangles indicated.

Step 3 Utilize Phillips screwdriver to loosen 14 screws to remove 2 Middle side plate as ovals indicated.

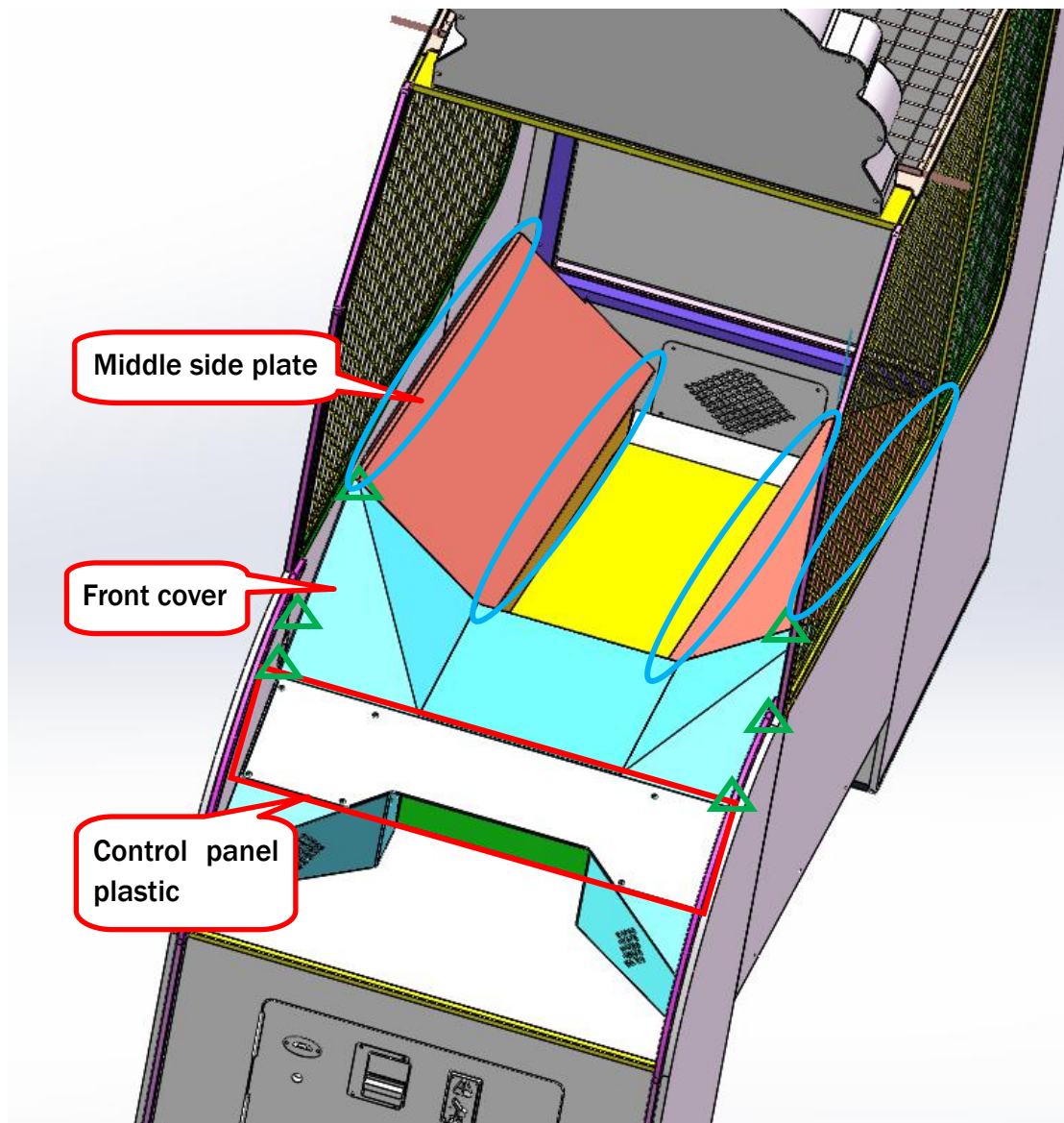

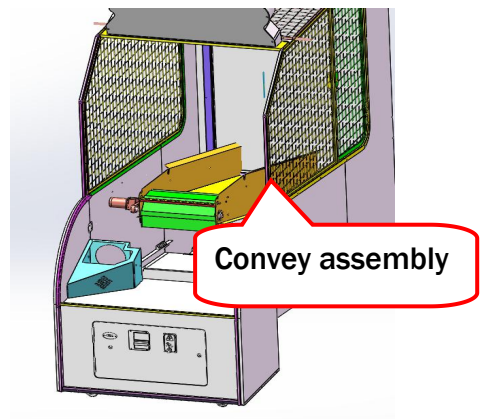
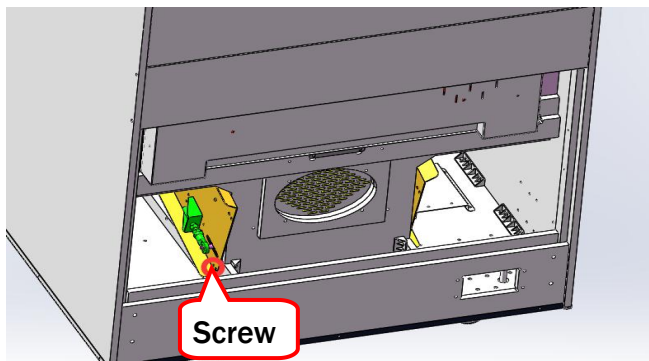

Step 4 Open the Back bottom door. Loosen 2 screws to remove Convey assembly.



8.4 Convey Belt Adjustment Instruction

Before processing with assembly assure you have the following tools.

No.	Name	Picture
1	Phillips screwdriver	
2	Spanner	

Step 1 Follow the 8.3 steps to remove the Convey assembly.

Step 2 Utilize Spanner to loosen No.1 Nut.

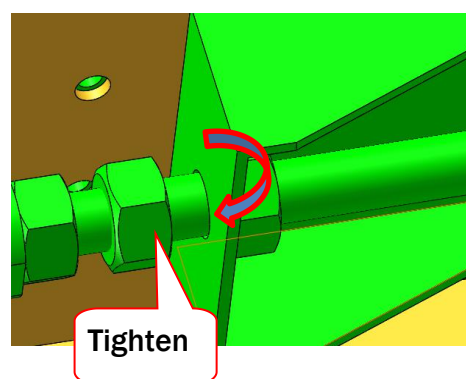
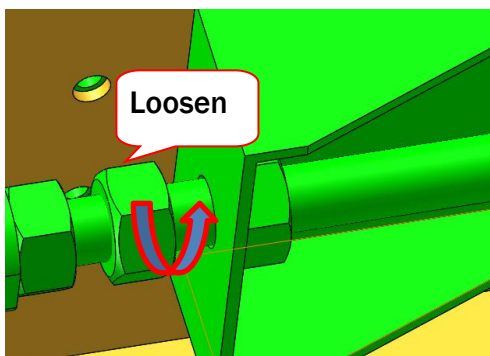
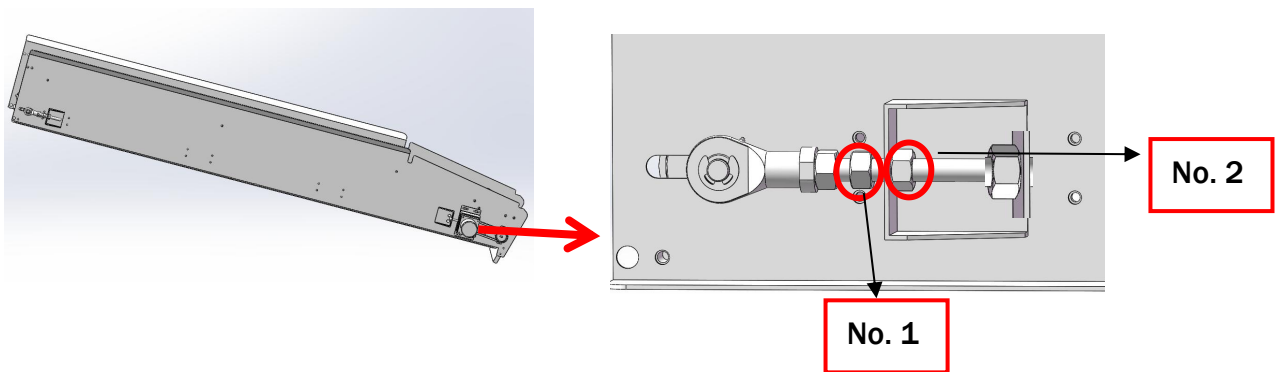

Step 3 Utilize Spanner to adjust No.2 Nut. Turn counterclockwise to loosen the Convey belt.

Turn clockwise to tighten the Convey belt.



8.5 Belt Adjustment Instruction

Before processing with assembly assure you have the following tools.

No.	Name	Picture
1	Phillips screwdriver	
2	Spanner	

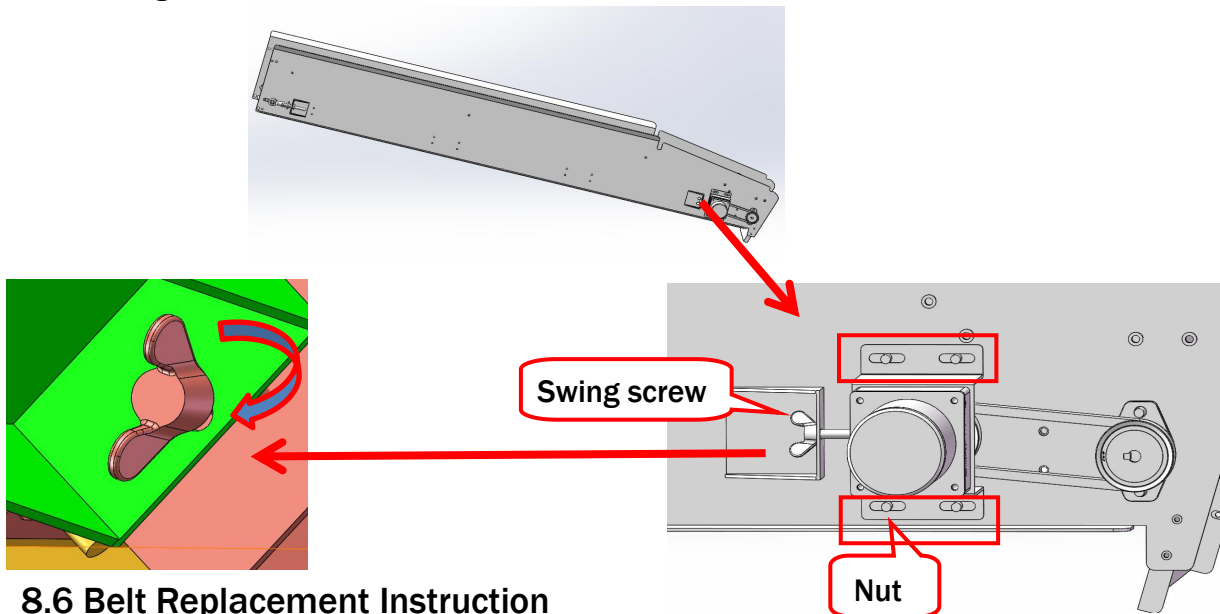

Step 1 Follow the 8.3 steps to remove the Convey assembly.

Step 2 Utilize Spanner to loosen 4 Nuts. Turn Swing screw clockwise to tighten the belt. Turn Swing screw clockwise to loosen the belt.



8.6 Belt Replacement Instruction

Before processing with assembly assure you have the following tools.

No.	Name	Picture
1	Phillips screwdriver	
2	Spanner	

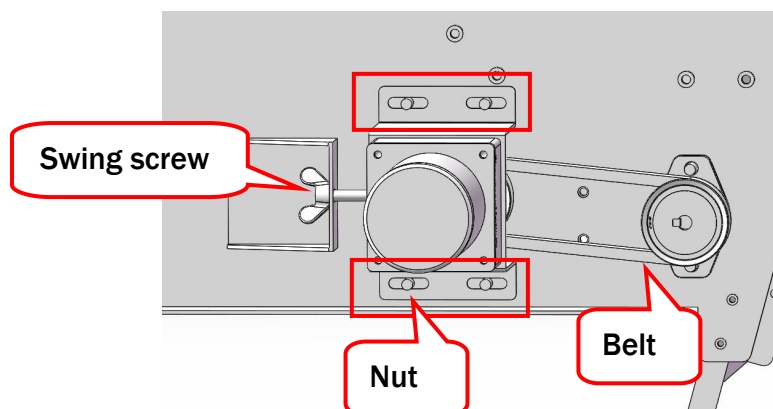

Step 1 Follow the 8.3 steps to remove the Convey assembly.

Step 2 Unplug Motor connector. Utilize Spanner to loosen 4 Nuts to remove motor. Remove swing screw. Replace with the new new Belt and install it in reversed order.



8.7 Sensor Replacement Instruction

Before processing with assembly assure you have the following tools.

No.	Name	Picture
1	Phillips screwdriver	
2	Socket	

Step 1 Power off the machine. Utilize Phillips screwdriver to loosen 8 screws, washers and screw holders to remove Control panel plastic and Scoreboard decal.

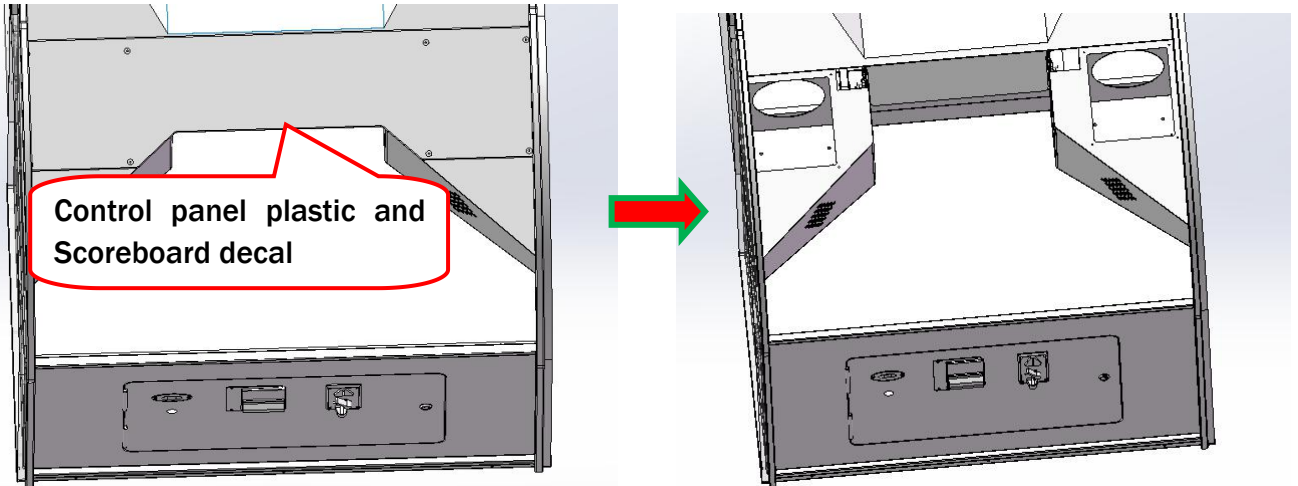

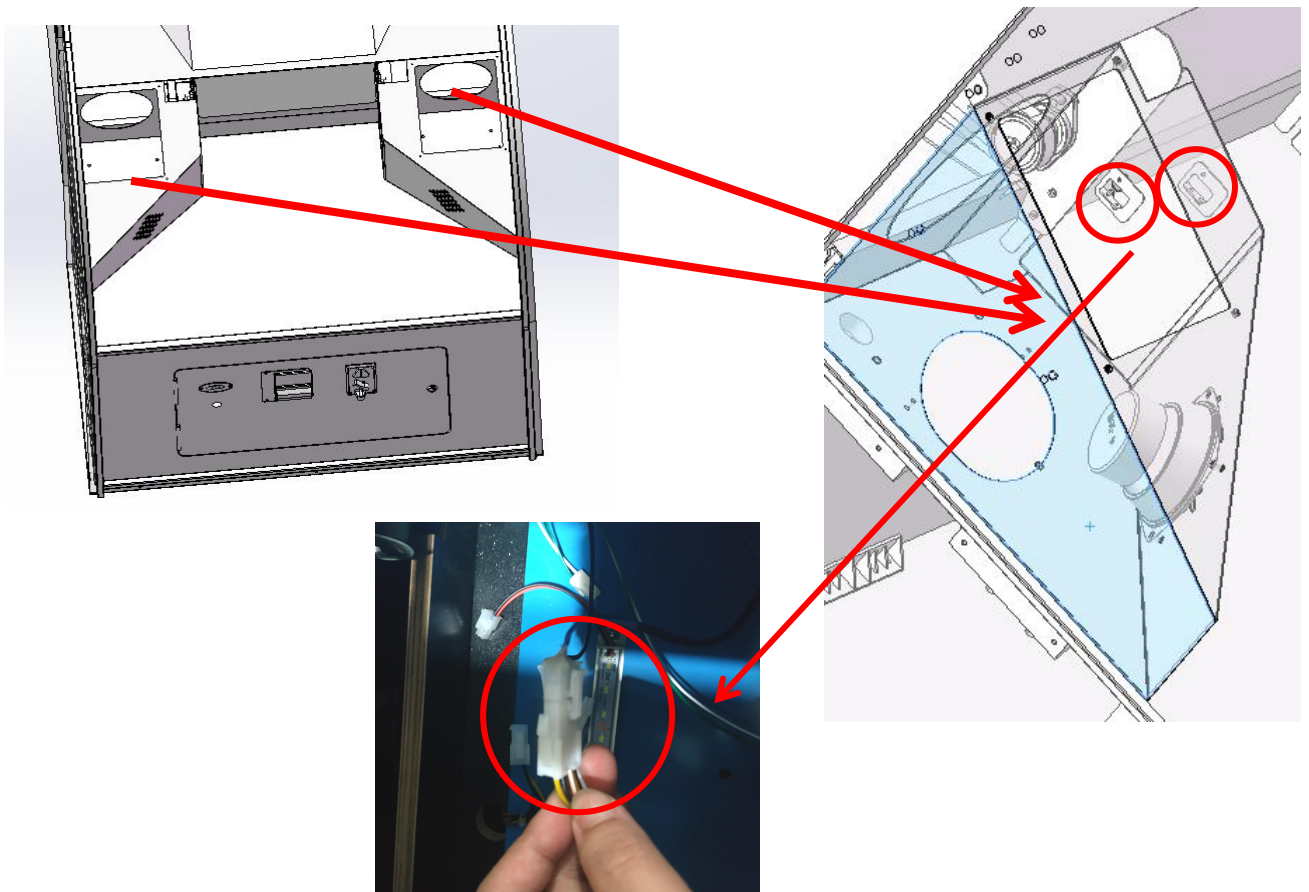

Step 2 Unplug Sensor connector. Utilize Socket to loosen 2 nuts to remove sensor. Replace with the new new Sensor and install it in reversed order.



8.8 Monitor Replacement Instruction

Before processing with assembly assure you have the following tools.

No.	Name	Picture
1	Phillips screwdriver	
2	Allen wrench	

Step 1 Power off the machine. Open Back upper door and Back bottom door. Utilize Allen wrench to loosen 8 screws to remove Back upper plate and Back middle plate.

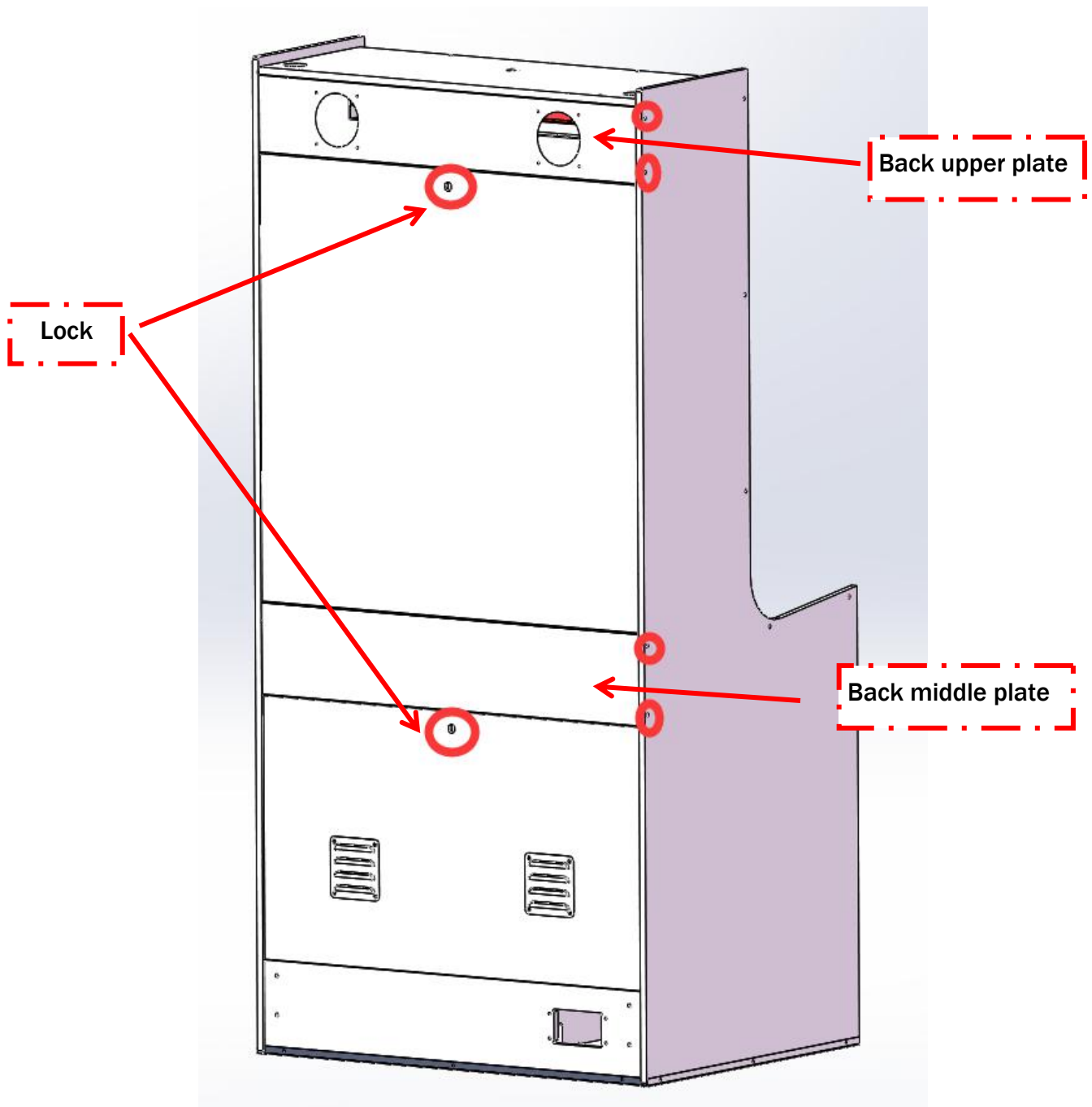

Step 2 Utilize Phillips screwdriver to loosen 12 screws to remove 2 Monitor outer fixing plates.

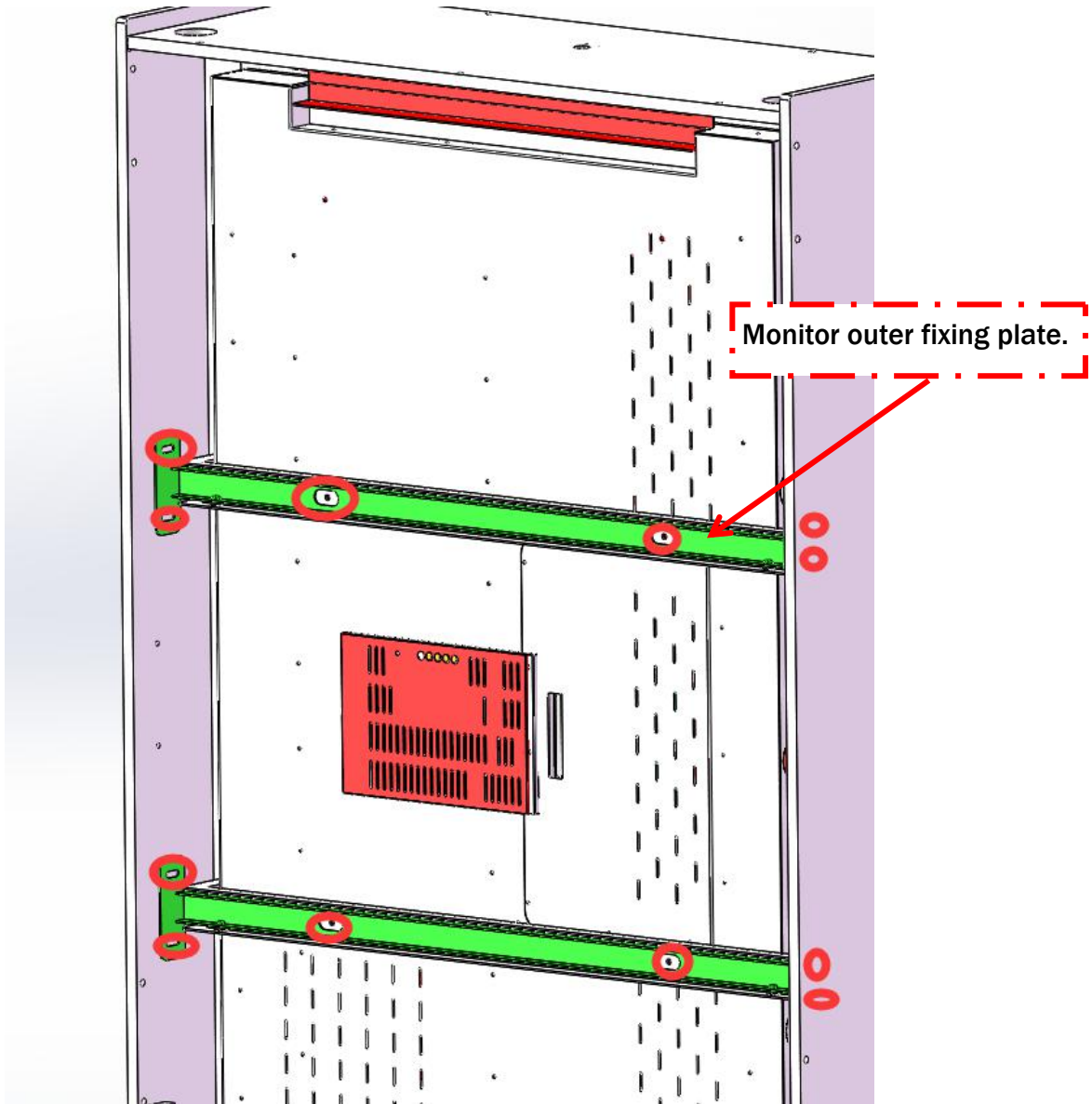

Step 3 Utilize Phillips screwdriver to loosen 6 screws to remove 3 Monitor pressing plates. Utilize Phillips screwdriver to loosen 8 screws to remove 4 Monitor fixing plates. Remove Monitor. Replace with the new Monitor and install it in reversed order.

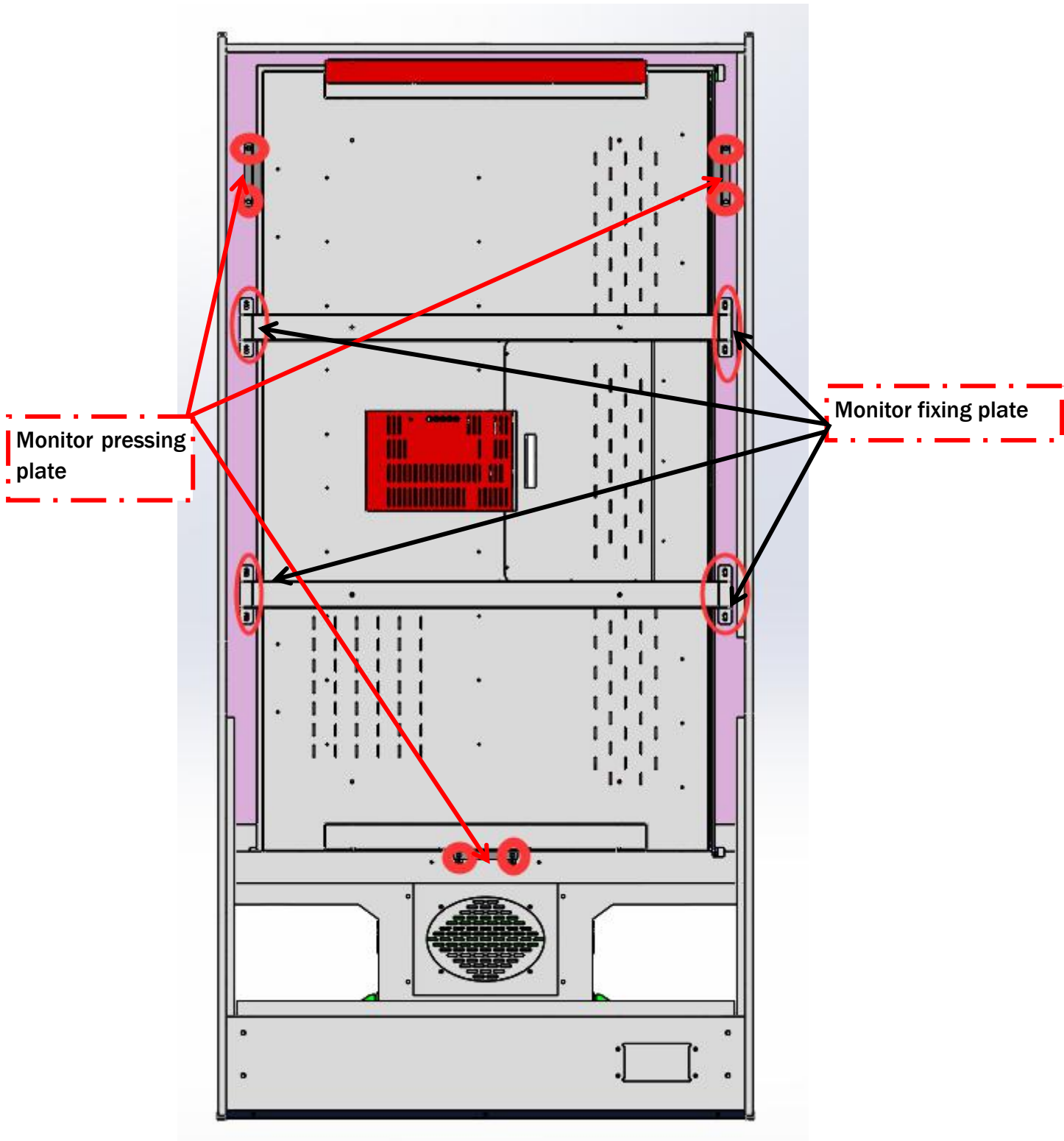

9. OVERALL CONSTRUCTION

9.1 Convey Assembly

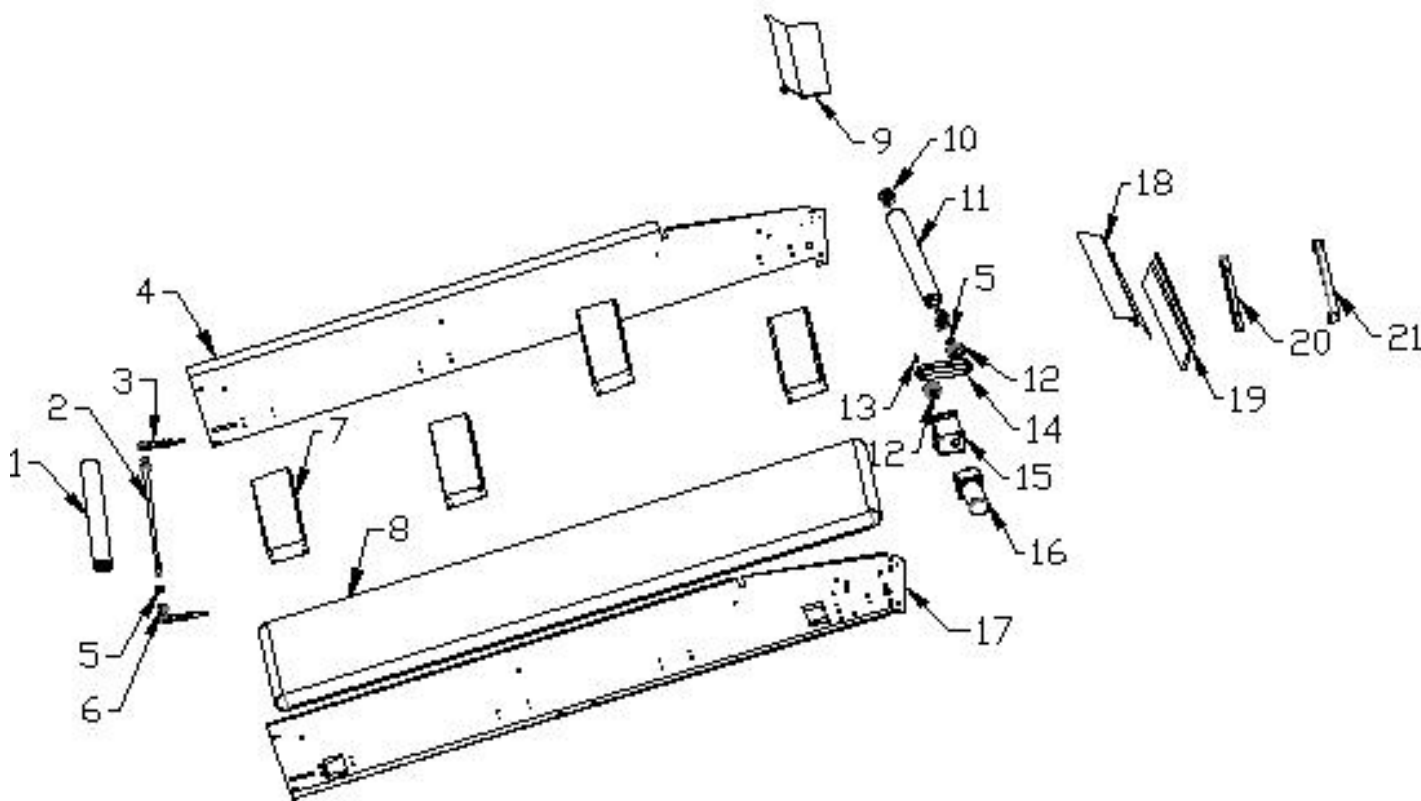

No.	Part No.	Code No.	Name	Qty
1	D161-191-000	20211804A048	Driven sleeve	1
2	D161-190-000	20211804A047	Driven axle	1
3	D161-405-000	20106080316	Rod bearing	2
4	D161-186-001	20211804A043A	Convey belt L side plate	1
5	D161-192-000	20211804A049	Washer	4
6	D161-407-000	20106000082	Bearing	2
7	D161-187-000	20211804A044	Connective plate	4
8	D161-193-000	20211804A050	Convey belt	1
9	D161-197-000	20211804A054	Protective plate	1
10	D161-403-000	20106130189	Bearing	2
11	D161-188-000	20211804A045	Driving axle	1
12	D161-217-000	20211702117	Conveying synchronous wheel	2
13	D161-195-000	20211804A052	Driven wheel flat key	1
14	D161-404-000	26504020001	Belt	1

No.	Part No.	Code No.	Name	Qty
15	D161-194-000	20211804A051	Motor bracket	1
16	D161-402-000	23404000261	Motor	1
17	D161-185-001	20211804A042A	Convey belt R side plate	1
18	D161-196-000	20211804A053	Al plate	1
19	D161-200-000	20211804A056	Hand protective plate	1
20	D161-198-001	20611804A017A	Control panel light strip plastic	1
21	D161-199-001	20211804A055A	Control panel light strip plate	1

9.2 Frame Assembly

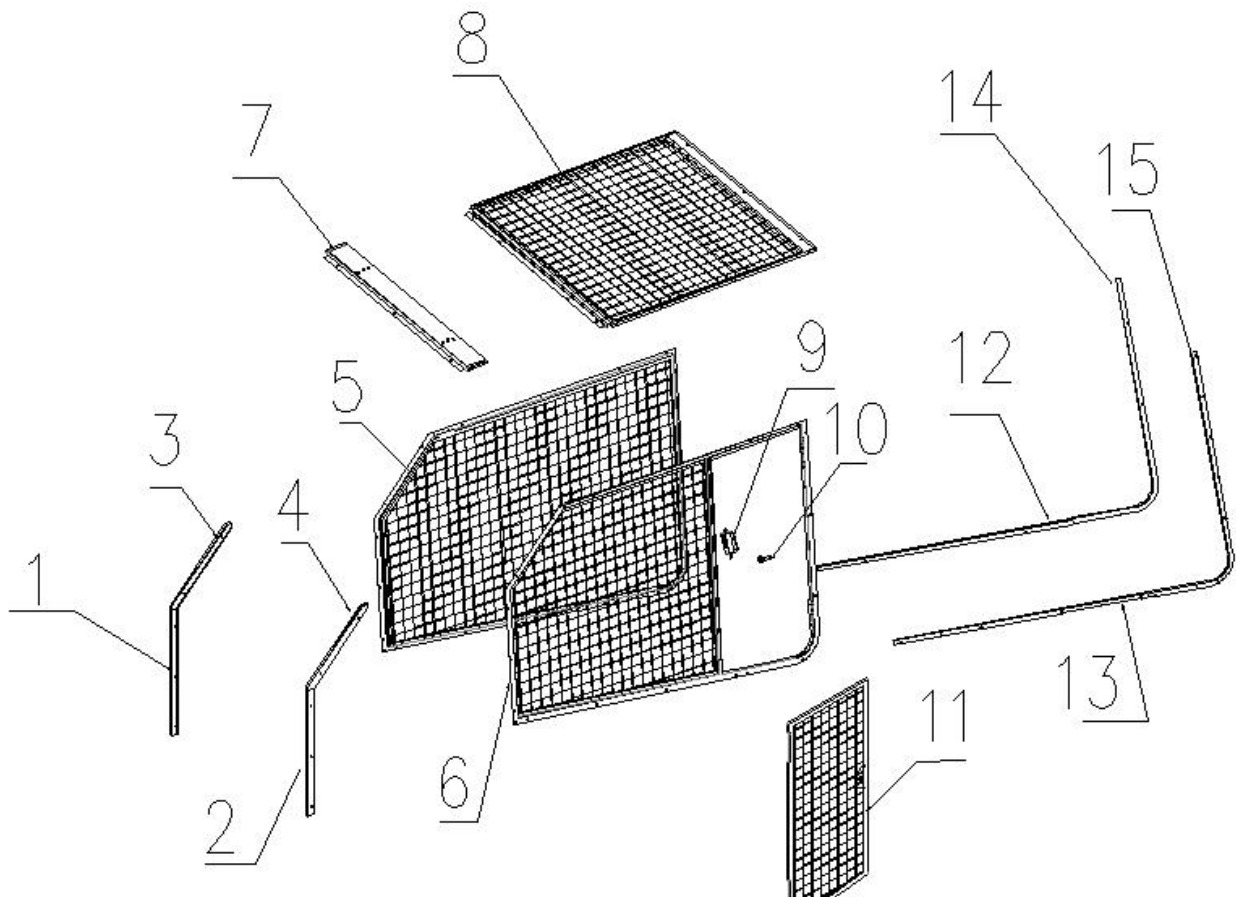

No.	Part No.	Code No.	Name	Qty
1	D161-209-000	20611804A016	L bottom frame plastic	1
2	D161-207-000	20611804A014	R bottom frame plastic	1
3	D161-208-000	20611804A015	L top frame plastic	1
4	D161-206-000	20611804A013	R top frame plastic	1
5	D161-203-001	20211804A029A	L frame	1

No.	Part No.	Code No.	Name	Qty
6	D161-201-001	20211804A027A	R frame	1
7	D161-215-000	20211804A037	Marquee fixing plate	1
8	D161-205-001	20211804A031A	Top net	1
9	D161-216-000	20211804A038	Back upper door lock cover	1
10	D161-401-000	25300171001	171 Lock	1
11	D161-214-001	20211804A036A	Back upper door	1
12	D161-210-000	20211804A032	L bottom frame fixing plate	1
13	D161-212-000	20211804A034	R bottom frame fixing plate	1
14	D161-211-000	20211804A033	L back frame fixing plate	1
15	D161-213-000	20211804A035	R back frame fixing plate	1

9.3 Control Panel Assembly

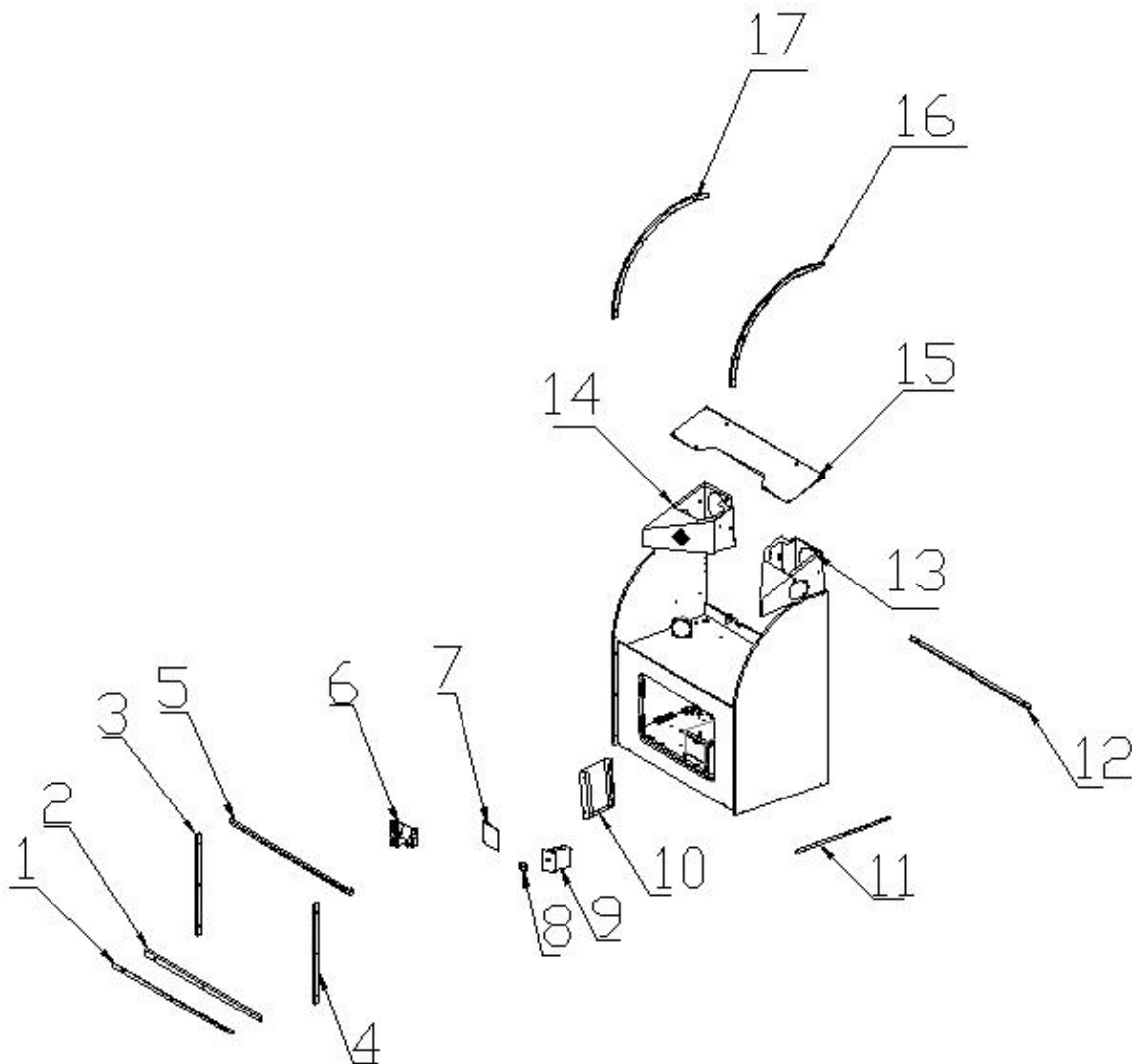

No.	Part No.	Code No.	Name	Qty
1	D161-135-000	20211804A007	Control panel bottom plate	1
2	D161-136-000	20611804A006	Control panel bottom plastic	1
3	D161-137-000	20611804A007	Control panel L bottom plastic	1
4	D161-132-000	20611804A004	Control panel R bottom plastic	1
5	D161-134-000	20211804A006	Control panel protect plate	1
6	D161-454-000	22301000002	Coin mechanism	1
7	D161-142-000	20211804A011	DBV plate	1
8	D161-401-000	25300171001	171 Lock	1
9	D161-455-000	23100000005	Ticket dispenser	1
10	D161-102-000	26000006000	Ticket box	1
11	D161-131-000	20211804A005	Control panel side plate	2
12	D161-139-001	20211804A008A	Side plate	1
13	D161-141-000	20211804A010	R bracket	1
14	D161-140-000	20211804A009	L bracket	1
15	D161-701-000	20511804A002	Control panel plastic	1
16	D161-133-000	20611804A005	Control panel R top plastic	1
17	D161-138-000	20611804A008	Control panel L top plastic	1

9.4 Monitor Assembly

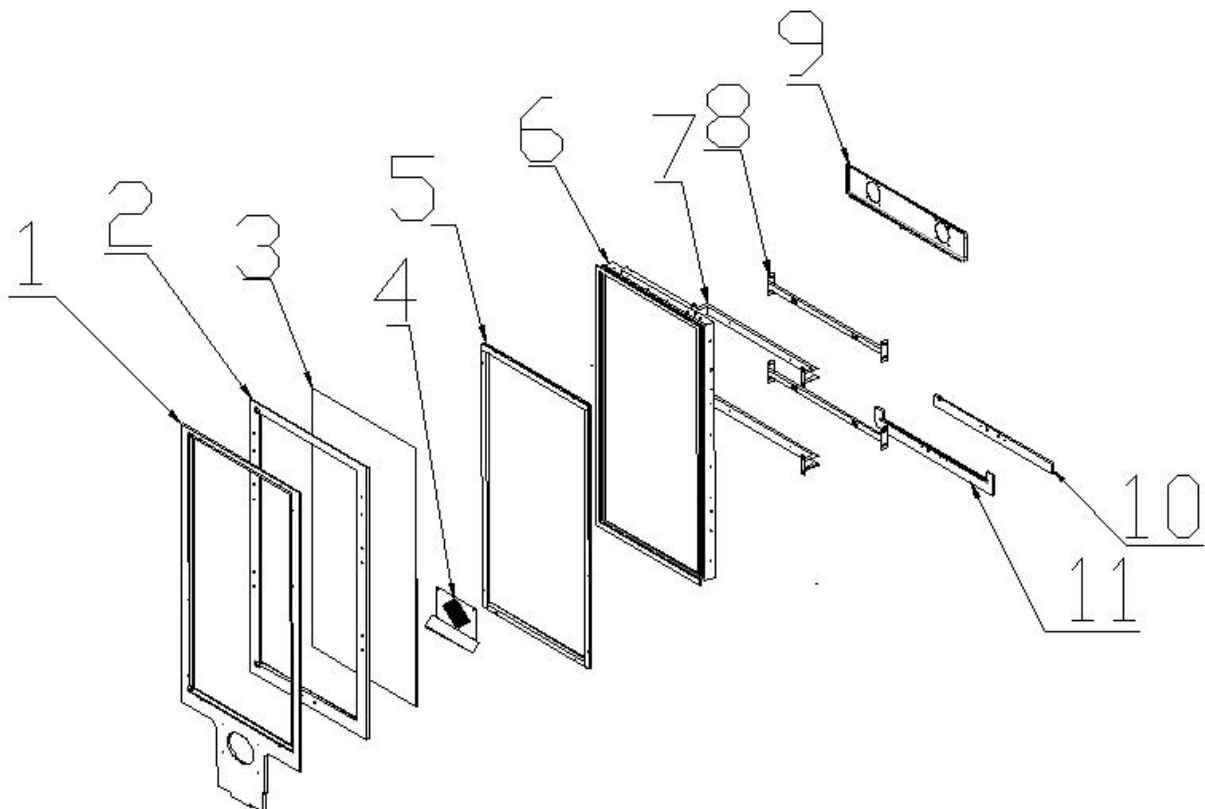

No.	Part No.	Code No.	Name	Qty
1	D161-160-000	20311804A028	Monitor support board	1
2	D161-159-001	20311804A027A	Glass pressing board	1
3	D161-415-000	21202065001	65"touch screen	1
4	D161-174-001	20211804A020A	Speaker net	1
5	D161-167-000	20611804A010	Monitor R light strip plastic	1
	D161-168-000	20611804A011	Monitor L light strip plastic	1
	D161-169-000	20611804A012	Monitor bottom light strip plastic	1
	D161-166-000	20611804A009	Monitor top light strip plastic	1
6	D161-414-000	21201065002	65" monitor	1
7	D161-179-001	20211804A024A	Monitor fixing plate	2
8	D161-180-001	20211804A025A	Monitor outer fixing plate	2
9	D161-172-000	20211804A018	Back upper plate	1
10	D161-162-000	20311804A008	Monitor board	1
11	D161-161-000	20311804A007	Monitor base board	1

9.5 Middle Side Assembly& Front plate

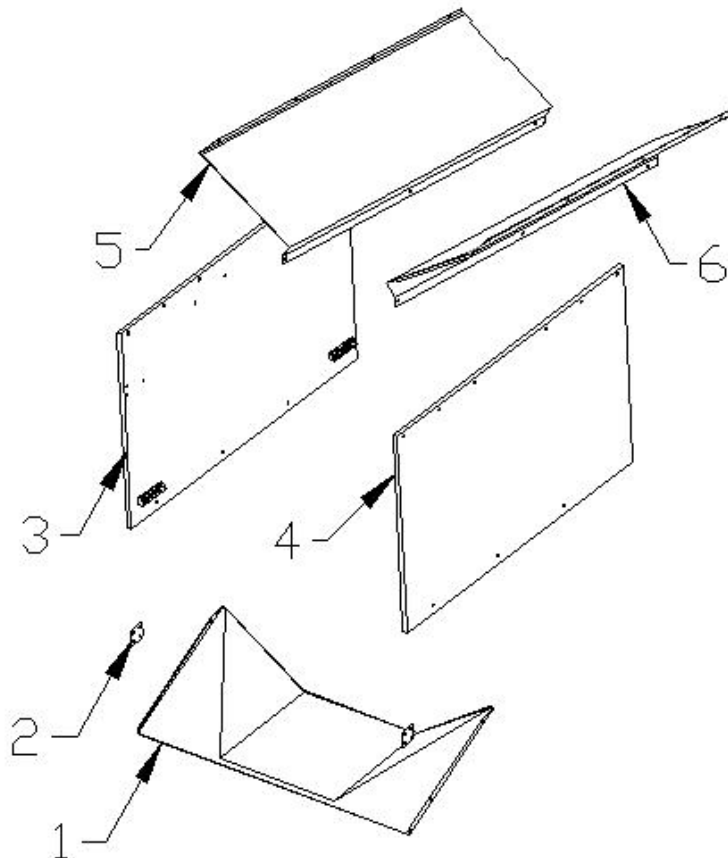

No.	Part No.	Code No.	Name	Qty
1	D161-118-000	20211804A002	Front cover	1
2	D161-117-000	20211804A001	Joint pin	2
3	D161-122-000	20311804A011	L side board	1
4	D161-121-000	20311804A010	R side board	1
5	D161-120-000	20211804A004	L middle side plate	1
6	D161-119-000	20211804A003	R middle side plate	1

9.6 Marquee Assembly

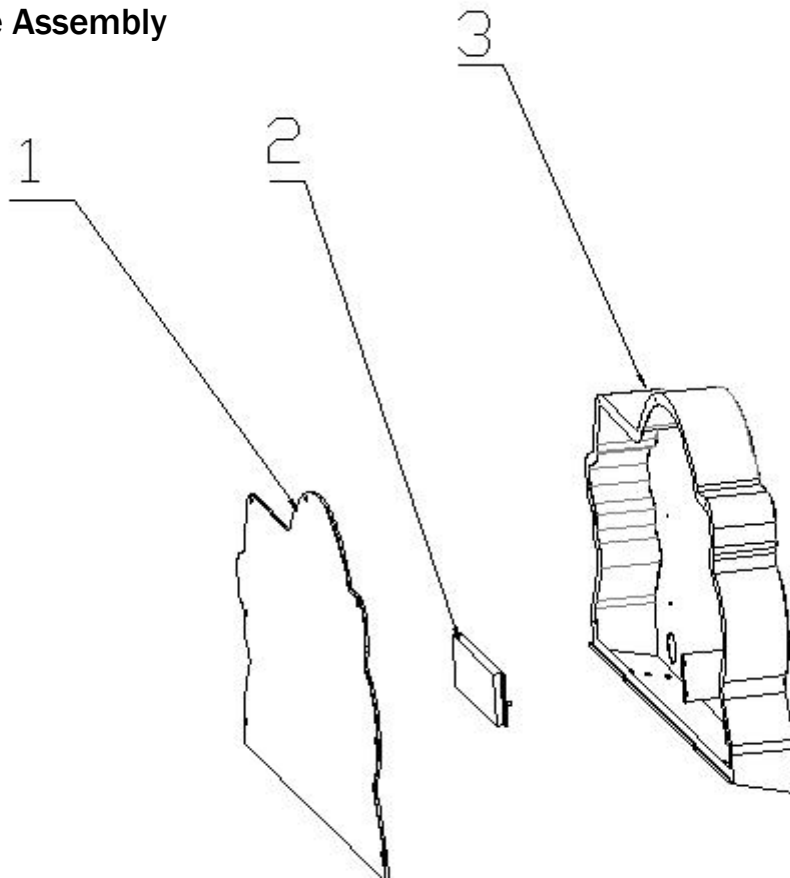

No.	Part No.	Code No.	Name	Qty
1	D161-702-000	20511804A001	Marquee plastic	1
2	D161-450-000	29741614004	Display	1
3	D161-145-000	20211804A013	Marquee frame	1

9.7 Wooden Assembly

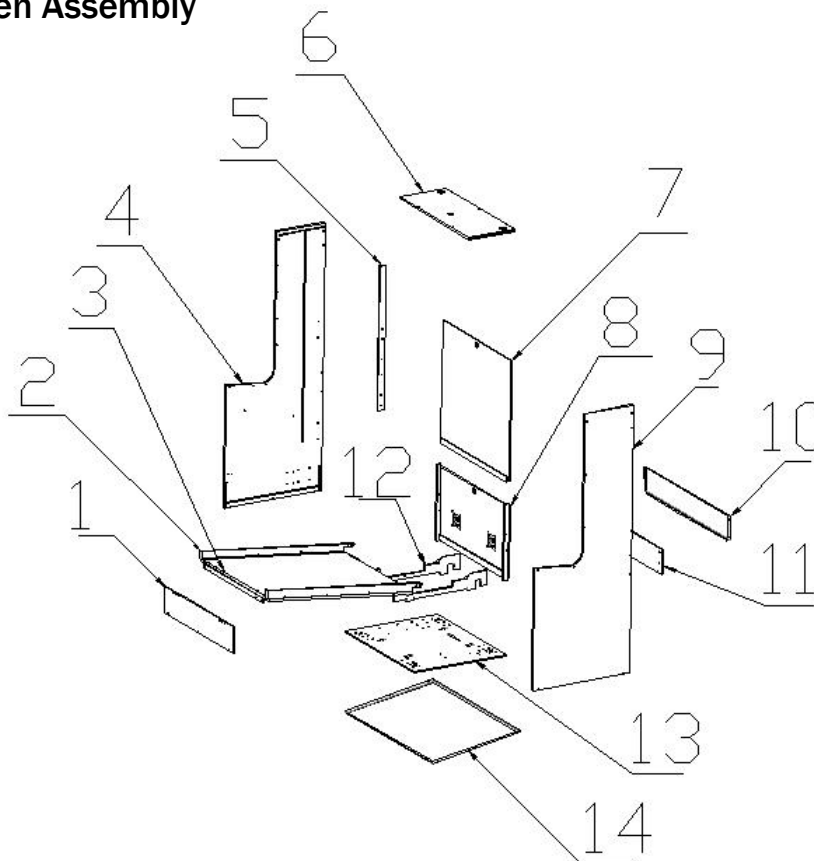

No.	Part No.	Code No.	Name	Qty
1	D161-151-000	20311804A023	Front board	1
2	D161-175-000	20211804A021	Bottom lane R plate	1
	D161-176-000	20211804A022	Bottom lane L plate	1
3	D161-153-000	20311804A024	Bottom lane board	1
4	D161-148-000	20311804A020	L board	1
5	D161-157-000	20311804A005	Back upper door vertical plate	2
6	D161-150-001	20311804A022A	Top board	1
7	D161-155-000	20311804A026	Back upper door board	1
8	D161-154-000	20311804A025	Back bottom door board	1
9	D161-147-000	20311804A019	R board	1
10	D161-171-000	20211804A017	Back middle plate	1
11	D161-149-000	20311804A021	Back bottom board	1
12	D161-152-000	20311804A003	Support board	2
13	D161-146-000	20311804A002	Base board	1
14	D161-177-000	20211804A023	Back plate	2
	D161-139-000	20211804A008	Side plate	2

9.8 Control Panel Wooden Case

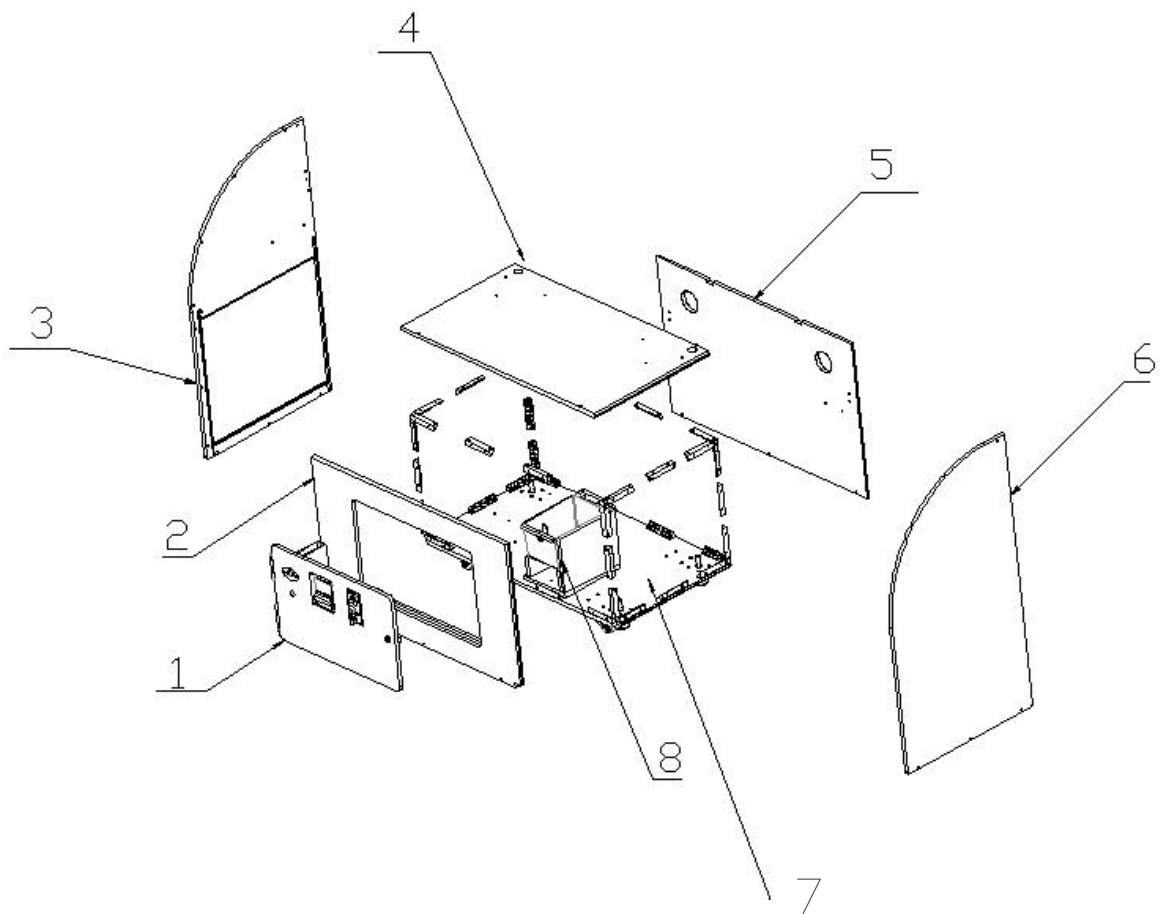

No.	Part No.	Code No.	Name	Qty
1	D161-129-000	20311804A017	Front door	1
2	D161-127-000	20311804A015	Control panel front board	1
3	D161-125-000	20311804A013	Control panel L side board	1
4	D161-126-000	20311804A014	Control panel board	1
5	D161-128-000	20311804A016	Control panel back board	1
6	D161-124-000	20311804A012	Control panel R side board	1
7	D161-123-001	20311804A001A	Control panel base board	1
8	D161-130-000	20311804A018	Coin box	1

9.9 Decals

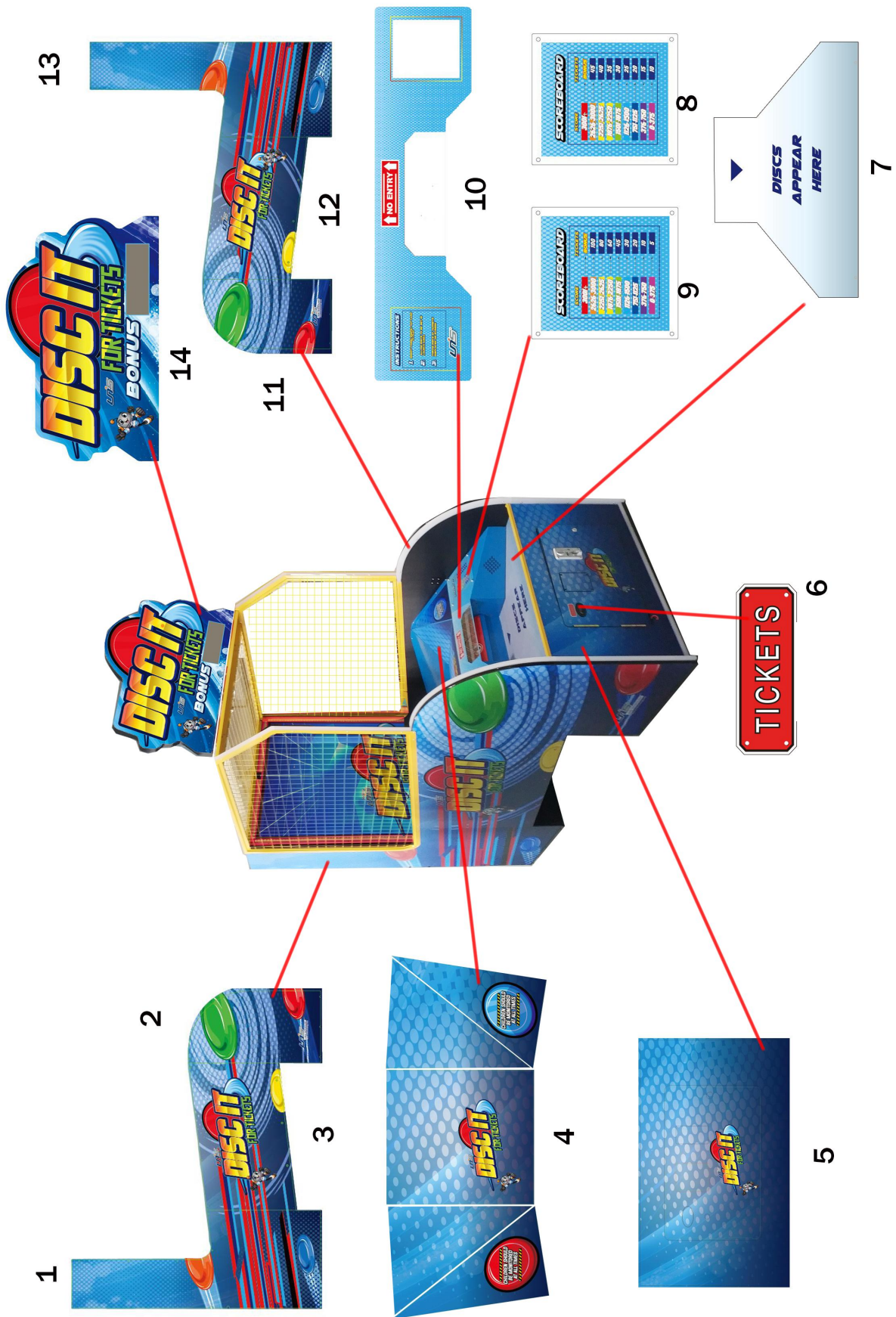

No.	Part No.	Code No.	Name	Qty
1	D161-736-000	20511804A021	L side decal 1	1
2	D161-740-000	20511804A025	L side decal 3	1
3	D161-738-000	20511804A023	L side decal 2	1
4	D161-719-000	20511804A005	Front cover decal	1
5	D161-717-000	20511804A007	Front door decal	1
6	D161-735-000	25600000108	Ticket decal	1
7	D161-718-000	20511804A006	Control panel decal	1
8	D161-716-000	20511804A008	Score board(large)	1
9	D161-715-000	20511804A009	Score board(small)	1
10	D161-701-001	20511804A002A	Control panel plastic	1
11	D161-741-000	20511804A026	R side decal 3	1
12	D161-739-000	20511804A024	R side decal 2	1
13	D161-737-000	20511804A022	R side decal 1	1

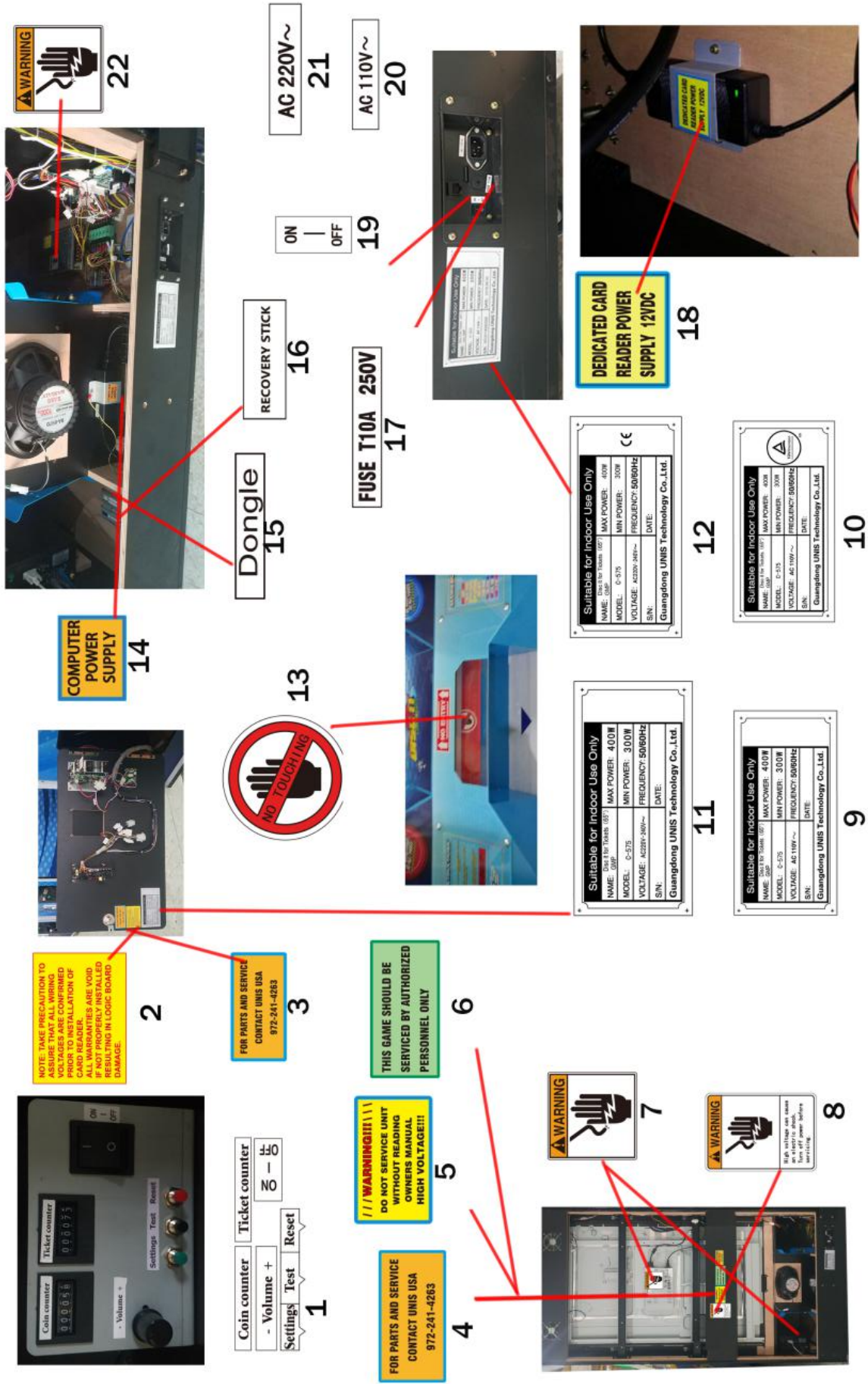

No.	Part No.	Code No.	Name	Qty
1	D161-707-000	20511804A017	Counter decal	1
2	D161-709-000	20511804A015	AAMA label	1
3	D161-733-000	25600000096A	Service label(small)	1
4	D161-732-000	25600000095A	Service label(orange)	1
5	D161-727-000	25600000067A	Service label(yellow)	1
6	D161-726-000	25600000042A	Service label(green)	1
7	D161-724-000	25600000036	High voltage(small)	2
8	D161-725-000	25600000037	High voltage(large)	1
9	D161-714-000	20511804A010	110V nameplate	2
10	D161-711-000	20511804A013	110V nameplate(TUV)	2
11	D161-713-000	20511804A011	220V nameplate(CE)	2
12	D161-712-000	20511804A012	220V nameplate	2
13	D161-734-000	25600000033	Stop touching label	1
14	D161-708-000	20511804A016	Computer power supply label	1
15	D161-731-000	25600000093	Dongle decal	1
16	D161-722-000	25600000116	Recovery stick decal	1
17	D161-703-000	25600000077	Fuse decal	1
18	D161-706-000	20511804A018	Adapter decal	1
19	D161-723-000	25600000016	Switch decal	1
20	D161-728-000	25600000071	110V decal	1
21	D161-729-000	25600000072	220V decal	1
22	D161-724-000	25600000036	High voltage(small)	1

No.	Part No.	Code No.	Name	Qty
1	D161-710-000	20511804A014	Wiring decal	1
2	D161-705-001	20511804A019A	Following accessory decal	1

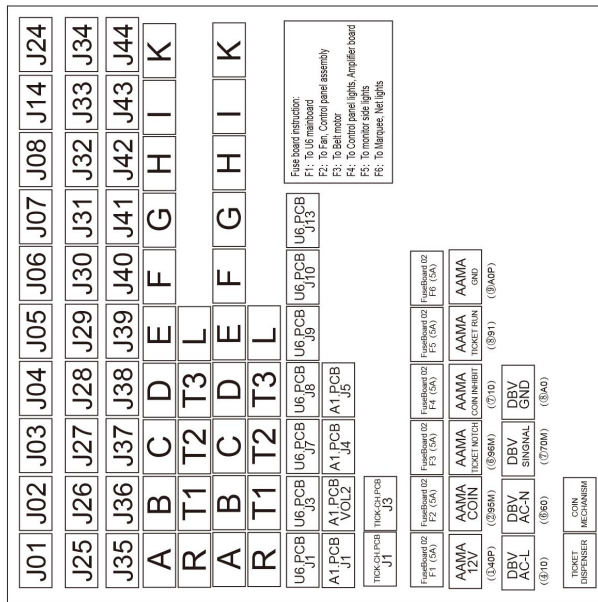

1

Disc it for Tickets (65") GMP			
Disc it for Tickets (65") GMP	Disc it for Tickets (65") GMP	Disc it for Tickets (65") GMP	Disc it for Tickets (65") GMP
PART NO. 21901000012	PART NO. Manual	PART NO. 25300172002	PART NO. 20101040005
SPEC. Ø5×20mm T5A 250VAC (UL)	SPEC. PVC	SPEC. 171B	SPEC. M4×12 Nickel plating
QTY. 1	QTY. 1	QTY. 1	QTY. 8
Disc it for Tickets (65") GMP	Disc it for Tickets (65") GMP	Disc it for Tickets (65") GMP	Disc it for Tickets (65") GMP
PART NO. 25300171002	PART NO. 25300172002	PART NO. 20101040024	PART NO. 20101020038
SPEC. 171	SPEC. 171B	SPEC. M4×12 Nickel plating	SPEC. M4×25 Color zinc
QTY. 2	QTY. 1	QTY. 70	QTY. 8
Disc it for Tickets (65") GMP	Disc it for Tickets (65") GMP	Disc it for Tickets (65") GMP	Disc it for Tickets (65") GMP
PART NO. 26000052000	PART NO. 21901000030B	PART NO. 21901000030B	PART NO. 23301010020
SPEC. Ø1	SPEC. Ø5×20mm T10A 250VAC (PSE UL)	SPEC. M6×16 Color zinc	SPEC. 3×16AWG 1.8M
QTY. 8	QTY. 1	QTY. 1	QTY. 1
Disc it for Tickets (65") GMP	Disc it for Tickets (65") GMP	Disc it for Tickets (65") GMP	Disc it for Tickets (65") GMP
PART NO. 20104020002	PART NO. 21901000030B	PART NO. 21901000030B	PART NO. 23302000011
SPEC. M6×16 Color zinc	SPEC. Ø5×20mm T10A 250VAC (PSE UL)	SPEC. M6×16 Color zinc	SPEC. T568A-T568A 1.5M
QTY. 20	QTY. 1	QTY. 1	QTY. 1

2

STEP1
Step 1: Use Phillips screwdriver to tighten 2 screws in the Upper bezel assembly to secure bezel.
The bezel assembly is shown in the diagram. The screws are labeled 'Screw'.

Name	Cross recessed pan head screw set
Spec.	M6X1.5
Qty.	2

STEP2
Step 2: Use Phillips screwdriver to tighten 2 screws in the Side plate to secure bezel assembly.
The side plate is shown in the diagram. The screws are labeled 'Screw'.

Name	Cross recessed pan head screw set
Spec.	M6X1.5
Qty.	2

STEP3
Step 3: Use Phillips screwdriver to tighten 2 screws in the Control panel to secure bezel assembly.
The control panel is shown in the diagram. The screws are labeled 'Screw'.

Name	Cross recessed pan head screw set
Spec.	M6X1.5
Qty.	2

STEP4
Step 4: Place side on the dot as shown below.

STEP5
Step 5: Use Phillips screwdriver to tighten 2 screws in the Upper bezel assembly to secure bezel.
The bezel assembly is shown in the diagram. The screws are labeled 'Screw'.

Name	Cross recessed pan head screw set
Spec.	M6X1.5
Qty.	2

STEP6
Step 6: Use Phillips screwdriver to tighten 2 screws in the Middle side plate to secure bezel assembly.
The middle side plate is shown in the diagram. The screws are labeled 'Screw'.

Name	Cross recessed pan head screw set
Spec.	M6X1.5
Qty.	2

STEP7
Step 7: Use Phillips screwdriver to tighten 2 screws in the Side plate to secure bezel assembly.
The side plate is shown in the diagram. The screws are labeled 'Screw'.

Name	Cross recessed pan head screw set
Spec.	M6X1.5
Qty.	2

STEP8
Step 8: Use Phillips screwdriver to tighten 2 screws in the Middle side plate to secure bezel assembly.
The middle side plate is shown in the diagram. The screws are labeled 'Screw'.

Name	Cross recessed pan head screw set
Spec.	M6X1.5
Qty.	2

STEP9
Step 9: Use Phillips screwdriver to tighten 2 screws in the Control panel to secure bezel assembly.
The control panel is shown in the diagram. The screws are labeled 'Screw'.

Name	Cross recessed pan head screw set
Spec.	M6X1.5
Qty.	2

STEP10
Step 10: Use Phillips screwdriver to tighten 2 screws in the Upper bezel assembly to secure bezel.
The bezel assembly is shown in the diagram. The screws are labeled 'Screw'.

Name	Cross recessed pan head screw set
Spec.	M6X1.5
Qty.	2

STEP11
Step 11: Use Phillips screwdriver to tighten 2 screws in the Control panel to secure bezel assembly.
The control panel is shown in the diagram. The screws are labeled 'Screw'.

Name	Cross recessed pan head screw set
Spec.	M6X1.5
Qty.	2

STEP12
Step 12: Use Phillips screwdriver to tighten 2 screws in the Middle side plate to secure bezel assembly.
The middle side plate is shown in the diagram. The screws are labeled 'Screw'.

Name	Cross recessed pan head screw set
Spec.	M6X1.5
Qty.	2

STEP13
Step 13: Use Phillips screwdriver to tighten 2 screws in the Upper bezel assembly to secure bezel.
The bezel assembly is shown in the diagram. The screws are labeled 'Screw'.

Name	Cross recessed pan head screw set
Spec.	M6X1.5
Qty.	2

STEP14
Step 14: Use Phillips screwdriver to tighten 2 screws in the Middle side plate to secure bezel assembly.
The middle side plate is shown in the diagram. The screws are labeled 'Screw'.

Name	Cross recessed pan head screw set
Spec.	M6X1.5
Qty.	2

STEP15
Step 15: Use Phillips screwdriver to tighten 2 screws in the Upper bezel assembly to secure bezel.
The bezel assembly is shown in the diagram. The screws are labeled 'Screw'.

Name	Cross recessed pan head screw set
Spec.	M6X1.5
Qty.	2

STEP16
Step 16: Use Phillips screwdriver to tighten 2 screws in the Middle side plate to secure bezel assembly.
The middle side plate is shown in the diagram. The screws are labeled 'Screw'.

Name	Cross recessed pan head screw set
Spec.	M6X1.5
Qty.	2

STEP17
Step 17: Use Phillips screwdriver to tighten 2 screws in the Upper bezel assembly to secure bezel.
The bezel assembly is shown in the diagram. The screws are labeled 'Screw'.

Name	Cross recessed pan head screw set
Spec.	M6X1.5
Qty.	2

STEP18
Step 18: Use Phillips screwdriver to tighten 2 screws in the Middle side plate to secure bezel assembly.
The middle side plate is shown in the diagram. The screws are labeled 'Screw'.

Name	Cross recessed pan head screw set
Spec.	M6X1.5
Qty.	2

STEP19
Step 19: Use Phillips screwdriver to tighten 2 screws in the Upper bezel assembly to secure bezel.
The bezel assembly is shown in the diagram. The screws are labeled 'Screw'.

Name	Cross recessed pan head screw set
Spec.	M6X1.5
Qty.	2

STEP20
Step 20: Use Phillips screwdriver to tighten 2 screws in the Middle side plate to secure bezel assembly.
The middle side plate is shown in the diagram. The screws are labeled 'Screw'.

Name	Cross recessed pan head screw set
Spec.	M6X1.5
Qty.	2

No.	Part No.	Code No.	Name	Qty
1	D161-704-000	20511804A020	Installation instruction decal	1

9.10 Electrical Components

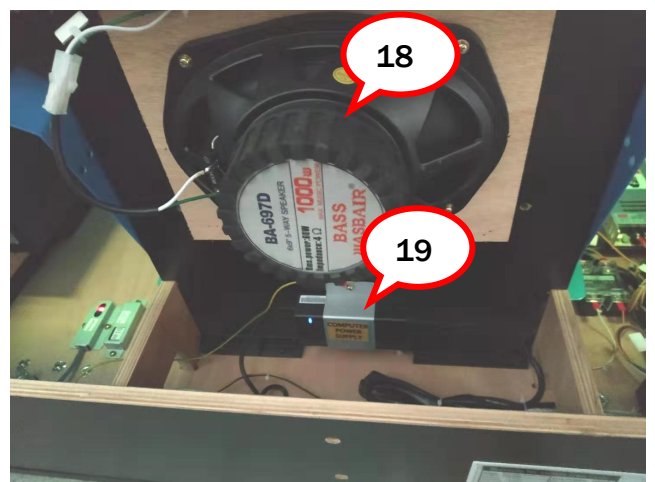
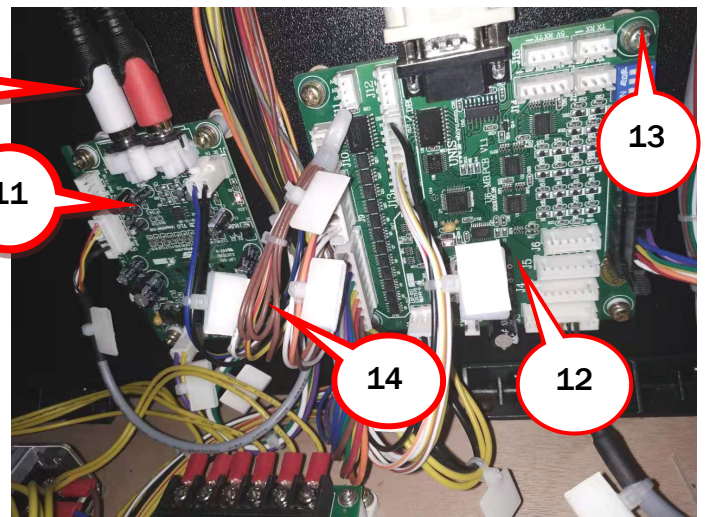
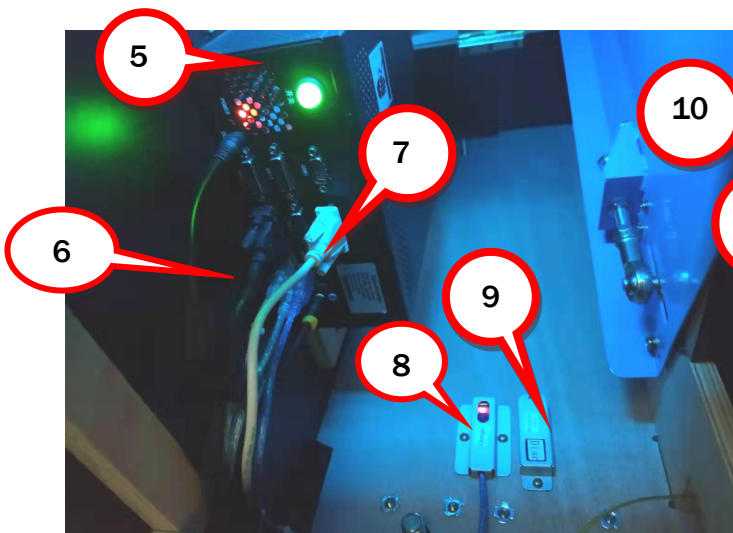
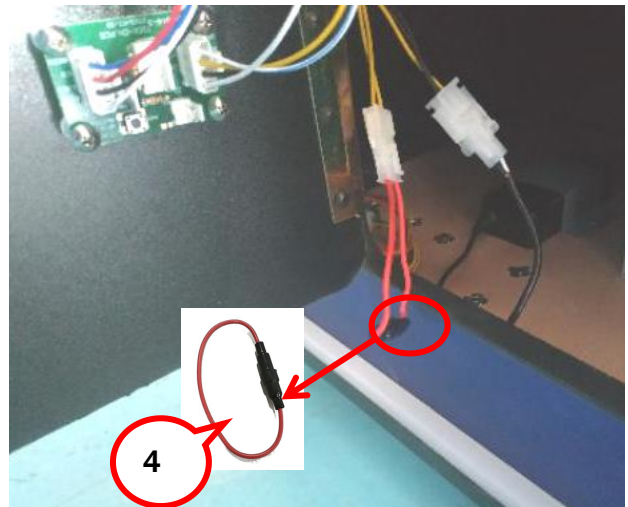
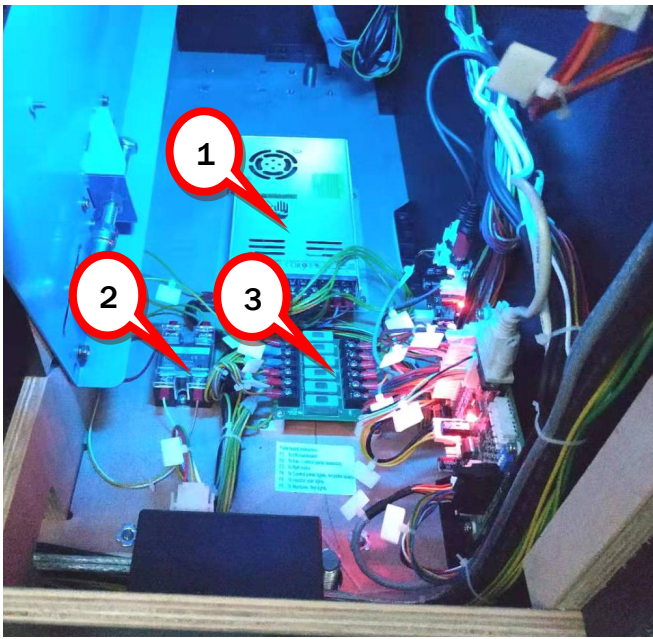

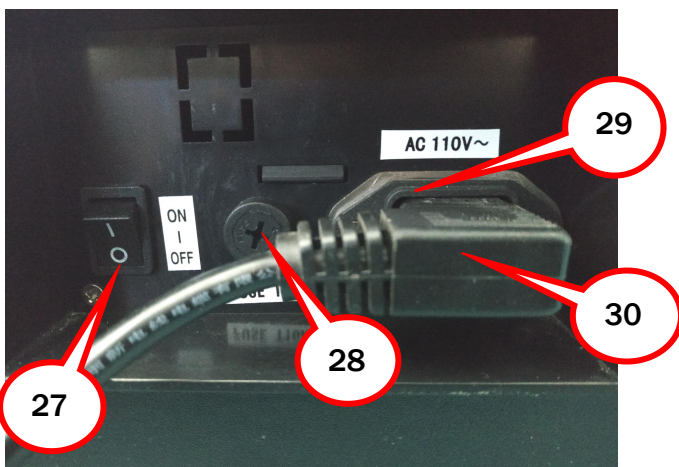
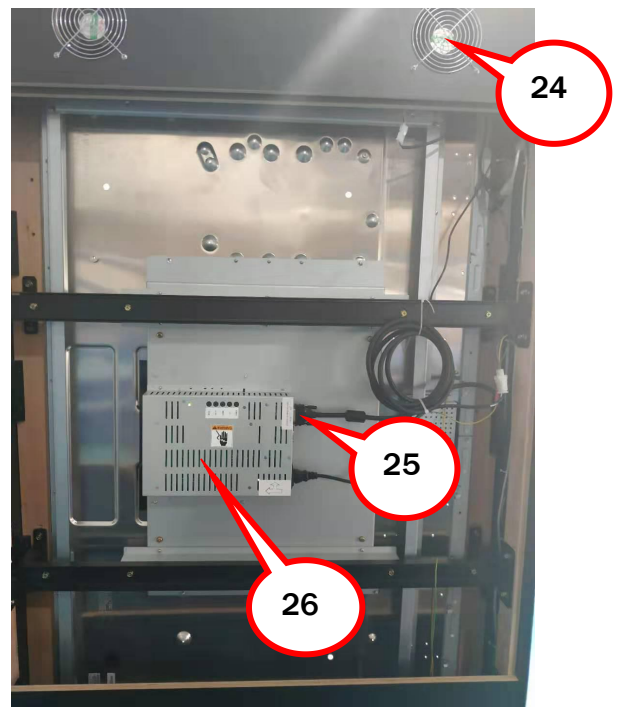
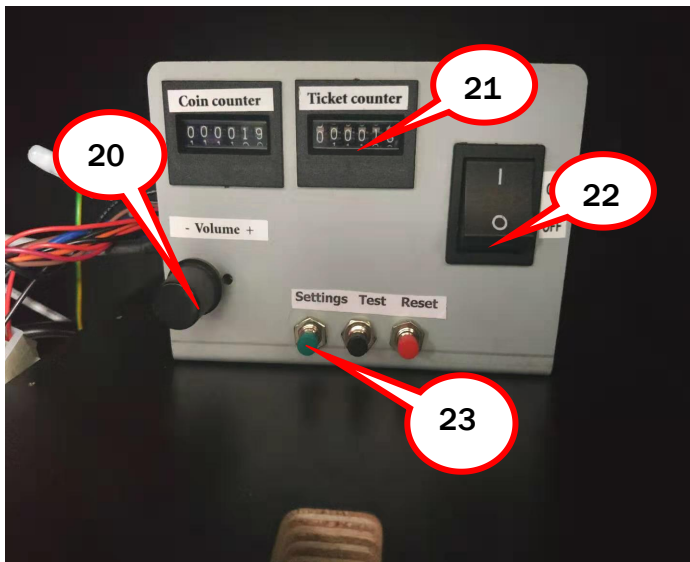

No.	Part No.	Code No.	Name	Qty
1	D161-427-000	21602000117	Power supply	1
2	D161-463-000	22140000029	Relay	1
3	D161-426-000	21714000148D	Fuse board(green holder)	1
4	D161-433-000	21901000012	Fuse	1
	D161-434-000	21902000024	Fuse holder	1
5	D161-413-000	21102000107	PC	1
	D161-465-000	26601090479	Mainboard	1
	D161-466-000	26601090480	Memory	2
	D161-467-000	26601090481	HDD	1
	D161-468-000	26601090482	CPU	1
	D161-469-000	26601090483	PC case	1
	D161-470-000	26601090484	PC power supply	1

No.	Part No.	Code No.	Name	Qty
6	D161-419-000	23304000033	Cable	1
	D161-420-000	23304010034	Extend cable	1
7	D161-421-000	23303000001	Serial cable	1
8	D161-416-000	21107020036	Dongle	1
9	D161-417-000	41300000007	Recovery stick	1
10	D161-422-000	23305000003	Audio cable	1
11	D161-425-000	29790300009	Amplifier	1
12	D161-424-000	29790300007A	U6 mainboard	1
13	D161-461-000	26000066001	Isolation column-female	12
	D161-462-000	26000066002	Isolation column-male	12
14	D161-435-000	23309000341	Cable set	1
15	D161-454-000	22301000002	Coin mechanism	1
16	D161-455-000	23100000005	Ticket dispenser	1
17	D161-456-000	29790700002	Ticket converted board	1
18	D161-443-000	22801000055	Speaker	1
19	D161-432-000	21603000027	AC adapter	1
20	D161-441-000	22403000001	POT	1
	D161-442-000	29791400001	POT connect board	1
21	D162-437-000	23000000006	Counter	4
22	D161-436-000	22601000042	Rocker switch(large)	1
23	D161-438-000	22402010002	Button(red)	1
	D161-439-000	22402030002	Button(green)	1
	D161-440-000	22402050001	Button(black)	1
24	D161-459-000	22702010025	Fan	2
	D161-460-000	22702000010	Fan net	4
25	D161-423-000	23307020001D	DVI cable	1
26	D161-414-000	21201065002	65" monitor	1
27	D161-430-000	22601000005	Rocker switch(small)	1
28	D161-429-000	21902000006	Fuse holder	1
	D161-428-000	21901000030B	Fuse	1
29	D161-431-000	23201000001A	Filter	1
30	D161-804-000	23301010020	Power cord	1

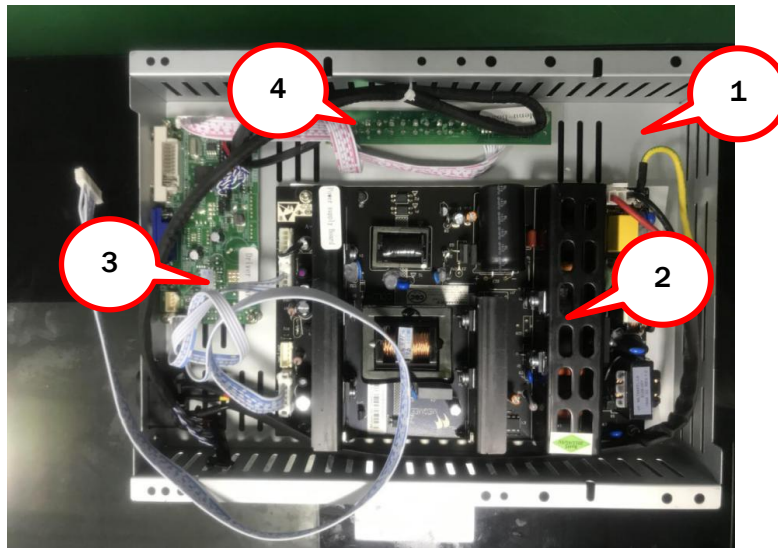

No.	Part No.	Code No.	Name	Qty
1	D161-471-000	26601101676	Chassis assembly of 65" monitor	1
2	D161-472-000	26601101677	Power board	1
3	D161-473-000	26601090487	Drive board	1
4	D161-474-000	26601090488	Key board	1

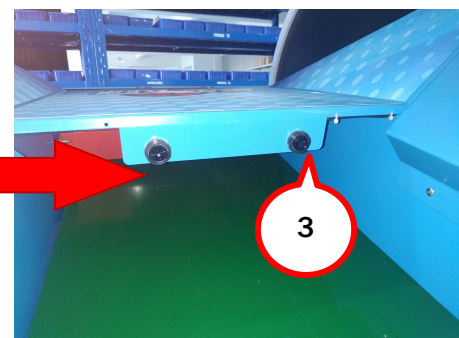
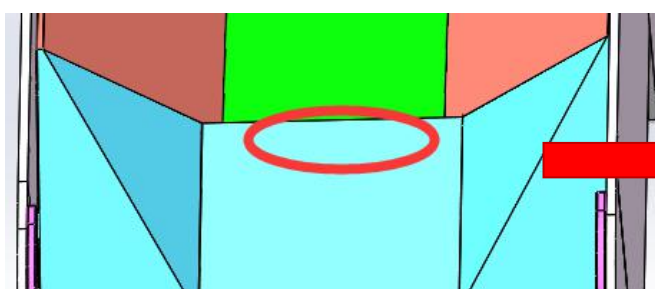
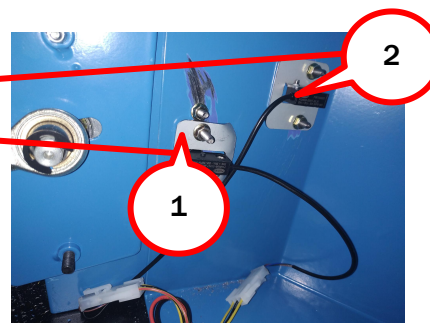
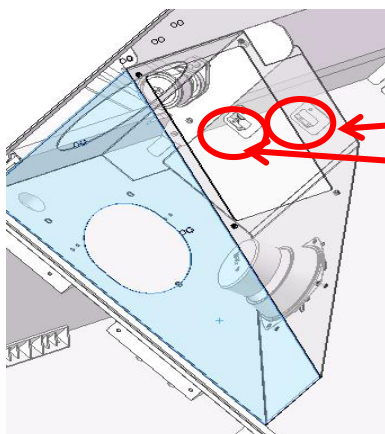

No.	Part No.	Code No.	Name	Qty
1	D161-446-000	21503000052	Sensor switch(send,2 pins)	1x2
2	D161-447-000	21503000053	Sensor switch(receive,3 pins)	1x2
3	D161-445-000	21501000047	Sensor	1x2



No.	Part No.	Code No.	Name	Qty
1	D161-452-000	22003080028	5630 light(11.81in)	1
	D161-453-000	22003080046	5630 light(25.59in)	2
2	D161-448-000	22002015021	BG5050RGB light strip	17.17in×2(0.45m×2)
3	D161-448-000	22002015021	BG5050RGB light strip	24.80in×2(0.63m×2)
4	D161-449-000	22002015019	BG5050W light strip	15.74in(0.4m)
	D161-451-000	22003080025	5630 light(5.90in)	2
5	D161-448-000	22002015021	BG5050RGB light strip	32.28in×2(0.82m×2)
6	D161-448-000	22002015021	BG5050RGB light strip	22.44in×2(0.57m×2)
7	D161-448-000	22002015021	BG5050RGB light strip	37.00in(0.94m)
8	D161-458-000	22201000028	12V white light bracket	1
	D162-462-000	22003000003	LED bulb	1
9	D161-448-000	22002015021	BG5050RGB light strip	32.67in×2(0.83m×2)
	D161-448-000	22002015021	BG5050RGB light strip	57.08in×2(1.45m×2)
10	D161-450-000	29741614004	Display	1
11	D161-444-000	22801000047	Speaker	2
12	D161-414-000	21201065002	65" monitor	1
13	D161-454-000	22301000002	Coin mechanism	1
14	D161-455-000	23100000005	Ticket dispenser	1

10. WIRING DIAGRAM

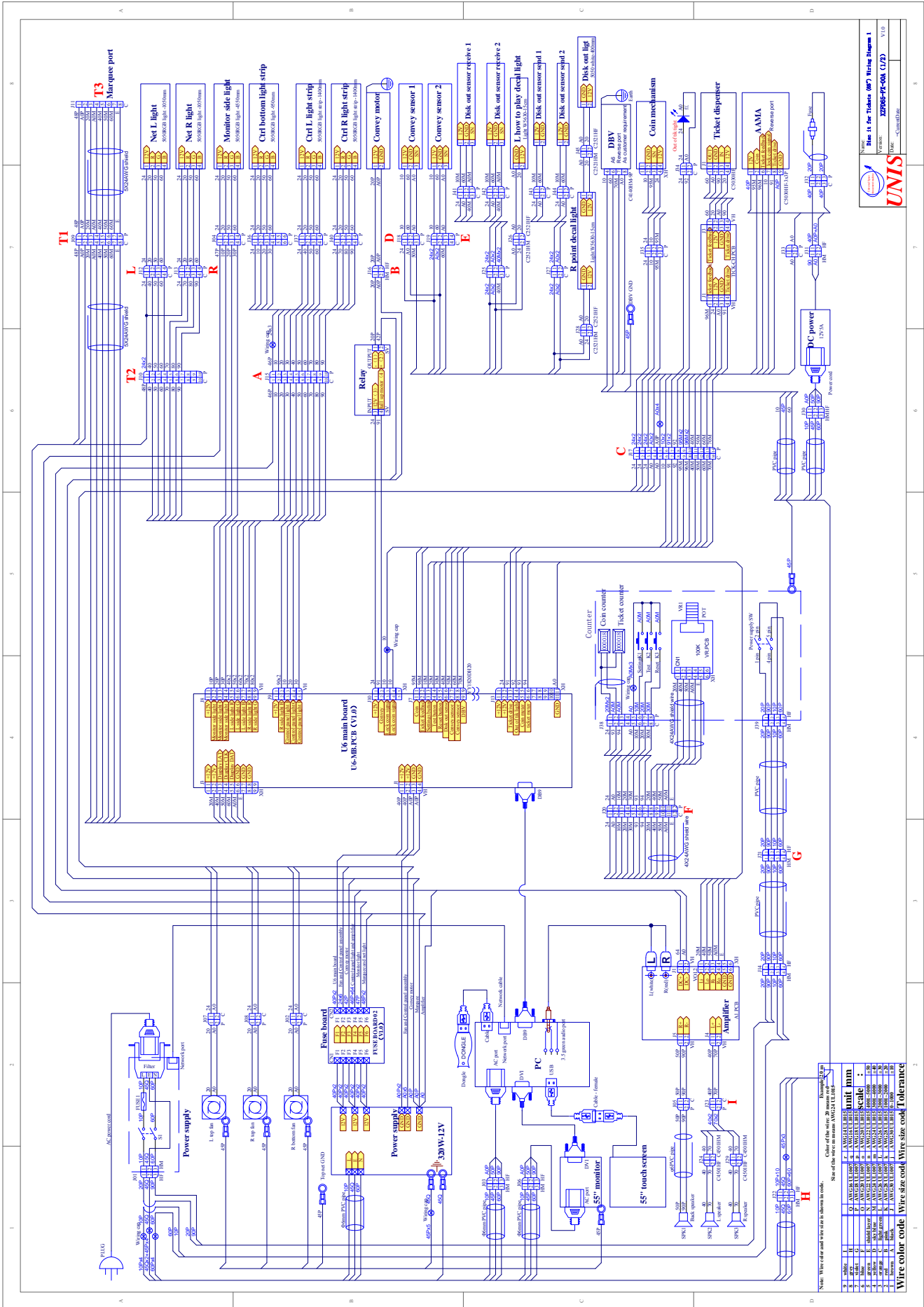

Disc it for Tickets (M7) Wiring Diagram 1

Version: 22/06/2014 (1/2)

Scale: 1:1

Author: [Name]

Checked: [Name]

Approved: [Name]

Date: [Date]

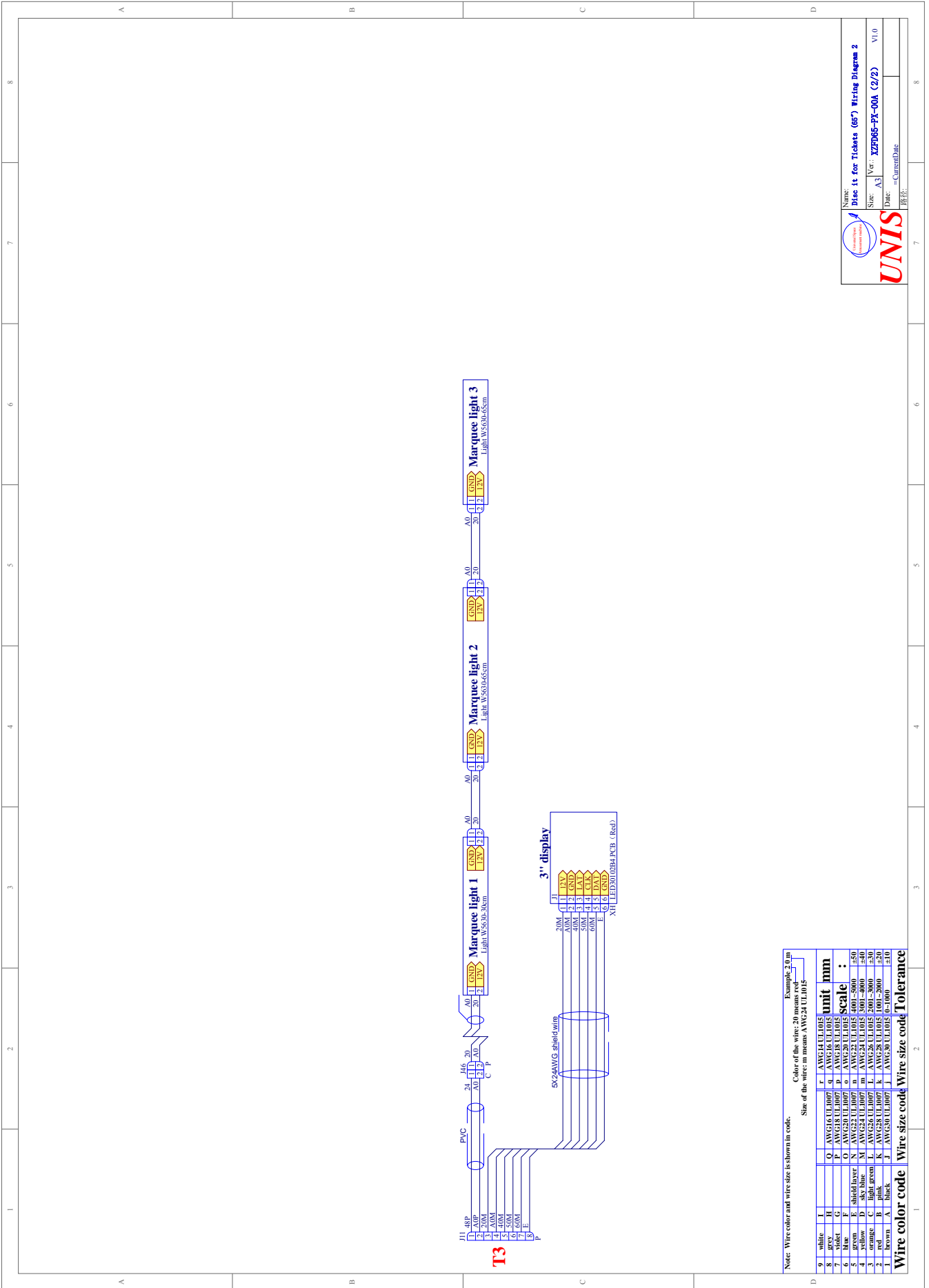

Note: Wire color and wire size is shown in code. Example: 20 in

Color of the wire: 20 means red

Wire color code	Wire size code	Wire size code	Tolerance
0	white	I	AWG14 UL1005
1	black	H	AWG16 UL1005
2	red	O	AWG16 UL1005
3	orange	P	AWG18 UL1005
4	yellow	Q	AWG18 UL1005
5	green	R	AWG20 UL1005
6	blue	S	AWG20 UL1005
7	violet	T	AWG24 UL1005
8	grey	U	AWG24 UL1005
9	pink	V	AWG24 UL1005
10	light green	W	AWG26 UL1005
11	light blue	X	AWG26 UL1005
12	light purple	Y	AWG28 UL1005
13	light yellow	Z	AWG28 UL1005
14	light orange	AA	AWG30 UL1005
15	light red	AB	AWG30 UL1005
16	light pink	AC	AWG30 UL1005
17	light blue	AD	AWG30 UL1005
18	light green	AE	AWG30 UL1005
19	light yellow	AF	AWG30 UL1005
20	light orange	AG	AWG30 UL1005
21	light red	AH	AWG30 UL1005
22	light pink	AI	AWG30 UL1005
23	light blue	AJ	AWG30 UL1005
24	light green	AK	AWG30 UL1005
25	light yellow	AL	AWG30 UL1005
26	light orange	AM	AWG30 UL1005
27	light red	AN	AWG30 UL1005
28	light pink	AO	AWG30 UL1005
29	light blue	AP	AWG30 UL1005
30	light green	AQ	AWG30 UL1005
31	light yellow	AR	AWG30 UL1005
32	light orange	AS	AWG30 UL1005
33	light red	AT	AWG30 UL1005
34	light pink	AU	AWG30 UL1005
35	light blue	AV	AWG30 UL1005
36	light green	AW	AWG30 UL1005
37	light yellow	AX	AWG30 UL1005
38	light orange	AY	AWG30 UL1005
39	light red	AZ	AWG30 UL1005
40	light pink	BA	AWG30 UL1005
41	light blue	BB	AWG30 UL1005
42	light green	BC	AWG30 UL1005
43	light yellow	BD	AWG30 UL1005
44	light orange	BE	AWG30 UL1005
45	light red	BF	AWG30 UL1005
46	light pink	BG	AWG30 UL1005
47	light blue	BH	AWG30 UL1005
48	light green	BI	AWG30 UL1005
49	light yellow	BJ	AWG30 UL1005
50	light orange	BK	AWG30 UL1005
51	light red	BL	AWG30 UL1005
52	light pink	BM	AWG30 UL1005
53	light blue	BN	AWG30 UL1005
54	light green	BO	AWG30 UL1005
55	light yellow	BP	AWG30 UL1005
56	light orange	BQ	AWG30 UL1005
57	light red	BR	AWG30 UL1005
58	light pink	BS	AWG30 UL1005
59	light blue	BT	AWG30 UL1005
60	light green	BU	AWG30 UL1005
61	light yellow	BV	AWG30 UL1005
62	light orange	BW	AWG30 UL1005
63	light red	BX	AWG30 UL1005
64	light pink	BY	AWG30 UL1005
65	light blue	BZ	AWG30 UL1005
66	light green	CA	AWG30 UL1005
67	light yellow	CB	AWG30 UL1005
68	light orange	CC	AWG30 UL1005
69	light red	CD	AWG30 UL1005
70	light pink	CE	AWG30 UL1005
71	light blue	CF	AWG30 UL1005
72	light green	CG	AWG30 UL1005
73	light yellow	CH	AWG30 UL1005
74	light orange	CI	AWG30 UL1005
75	light red	CJ	AWG30 UL1005
76	light pink	CK	AWG30 UL1005
77	light blue	CL	AWG30 UL1005
78	light green	CM	AWG30 UL1005
79	light yellow	CN	AWG30 UL1005
80	light orange	CO	AWG30 UL1005
81	light red	CP	AWG30 UL1005
82	light pink	CQ	AWG30 UL1005
83	light blue	CR	AWG30 UL1005
84	light green	CS	AWG30 UL1005
85	light yellow	CT	AWG30 UL1005
86	light orange	CU	AWG30 UL1005
87	light red	CV	AWG30 UL1005
88	light pink	CW	AWG30 UL1005
89	light blue	CX	AWG30 UL1005
90	light green	CY	AWG30 UL1005
91	light yellow	CZ	AWG30 UL1005
92	light orange	DA	AWG30 UL1005
93	light red	DB	AWG30 UL1005
94	light pink	DC	AWG30 UL1005
95	light blue	DD	AWG30 UL1005
96	light green	DE	AWG30 UL1005
97	light yellow	DF	AWG30 UL1005
98	light orange	DG	AWG30 UL1005
99	light red	DH	AWG30 UL1005
100	light pink	DI	AWG30 UL1005
101	light blue	DJ	AWG30 UL1005
102	light green	DK	AWG30 UL1005
103	light yellow	DL	AWG30 UL1005
104	light orange	DM	AWG30 UL1005
105	light red	DN	AWG30 UL1005
106	light pink	DO	AWG30 UL1005
107	light blue	DP	AWG30 UL1005
108	light green	DQ	AWG30 UL1005
109	light yellow	DR	AWG30 UL1005
110	light orange	DS	AWG30 UL1005
111	light red	DT	AWG30 UL1005
112	light pink	DU	AWG30 UL1005
113	light blue	DV	AWG30 UL1005
114	light green	DW	AWG30 UL1005
115	light yellow	DX	AWG30 UL1005
116	light orange	DY	AWG30 UL1005
117	light red	DZ	AWG30 UL1005
118	light pink	EA	AWG30 UL1005
119	light blue	EB	AWG30 UL1005
120	light green	EC	AWG30 UL1005
121	light yellow	ED	AWG30 UL1005
122	light orange	EE	AWG30 UL1005
123	light red	EF	AWG30 UL1005
124	light pink	EG	AWG30 UL1005
125	light blue	EH	AWG30 UL1005
126	light green	EI	AWG30 UL1005
127	light yellow	EJ	AWG30 UL1005
128	light orange	EK	AWG30 UL1005
129	light red	EL	AWG30 UL1005
130	light pink	EM	AWG30 UL1005
131	light blue	EN	AWG30 UL1005
132	light green	EO	AWG30 UL1005
133	light yellow	EP	AWG30 UL1005
134	light orange	EQ	AWG30 UL1005
135	light red	ER	AWG30 UL1005
136	light pink	ES	AWG30 UL1005
137	light blue	ET	AWG30 UL1005
138	light green	EU	AWG30 UL1005
139	light yellow	EV	AWG30 UL1005
140	light orange	EW	AWG30 UL1005
141	light red	EX	AWG30 UL1005
142	light pink	EY	AWG30 UL1005
143	light blue	EZ	AWG30 UL1005
144	light green	FA	AWG30 UL1005
145	light yellow	FB	AWG30 UL1005
146	light orange	FC	AWG30 UL1005
147	light red	FD	AWG30 UL1005
148	light pink	FE	AWG30 UL1005
149	light blue	FF	AWG30 UL1005
150	light green	FG	AWG30 UL1005
151	light yellow	FH	AWG30 UL1005
152	light orange	FI	AWG30 UL1005
153	light red	FJ	AWG30 UL1005
154	light pink	FK	AWG30 UL1005
155	light blue	FL	AWG30 UL1005
156	light green	FM	AWG30 UL1005
157	light yellow	FN	AWG30 UL1005
158	light orange	FO	AWG30 UL1005
159	light red	FP	AWG30 UL1005
160	light pink	FQ	AWG30 UL1005
161	light blue	FR	AWG30 UL1005
162	light green	FS	AWG30 UL1005
163	light yellow	FT	AWG30 UL1005
164	light orange	FU	AWG30 UL1005
165	light red	FV	AWG30 UL1005
166	light pink	FW	AWG30 UL1005
167	light blue	FX	AWG30 UL1005
168	light green	FY	AWG30 UL1005
169	light yellow	FZ	AWG30 UL1005
170	light orange	GA	AWG30 UL1005
171	light red	GB	AWG30 UL1005
172	light pink	GC	AWG30 UL1005
173	light blue	GD	AWG30 UL1005
174	light green	GE	AWG30 UL1005
175	light yellow	GF	AWG30 UL1005
176	light orange	GF	AWG30 UL1005
177	light red	GG	AWG30 UL1005
178	light pink	GH	AWG30 UL1005
179	light blue	GI	AWG30 UL1005
180	light green	GJ	AWG30 UL1005
181	light yellow	GK	AWG30 UL1005
182	light orange	GL	AWG30 UL1005
183	light red	GM	AWG30 UL1005
184	light pink	GN	AWG30 UL1005
185	light blue	GO	AWG30 UL1005
186	light green	GP	AWG30 UL1005
187	light yellow	GQ	AWG30 UL1005
188	light orange	GR	AWG30 UL1005
189	light red	GS	AWG30 UL1005
190	light pink	GT	AWG30 UL1005
191	light blue	GU	AWG30 UL1005
192	light green	GV	AWG30 UL1005
193	light yellow	GW	AWG30 UL1005
194	light orange	GX	AWG30 UL1005
195	light red	GY	AWG30 UL1005
196	light pink	GZ	AWG30 UL1005
197	light blue	HA	AWG30 UL1005
198	light green	HB	AWG30 UL1005
199	light yellow	HC	AWG30 UL1005
200	light orange	HD	AWG30 UL1005
201	light red	HE	AWG30 UL1005
202	light pink	HF	AWG30 UL1005
203	light blue	HG	AWG30 UL1005
204	light green	HH	AWG30 UL1005
205	light yellow	HI	AWG30 UL1005
206	light orange	HJ	AWG30 UL1005
207	light red	HK	AWG30 UL1005
208	light pink	HL	AWG30 UL1005
209	light blue	HM	AWG30 UL1005
210	light green	HN	AWG30 UL1005
211	light yellow	HO	AWG30 UL1005
212	light orange	HP	AWG30 UL1005
213	light red	HQ	AWG30 UL1005
214	light pink	HR	AWG30 UL1005
215	light blue	HS	AWG30 UL1005
216	light green	HT	AWG30 UL1005
217	light yellow	HU	AWG30 UL1005
218	light orange	HV	AWG30 UL1005
219	light red	HW	AWG30 UL1005
220	light pink	HX	AWG30 UL1005
221	light blue	HY	AWG30 UL1005
222	light green	HZ	AWG30 UL1005
223	light yellow	IA	AWG30 UL1005
224	light orange	IB	AWG30 UL1005
225	light red	IC	AWG30 UL1005
226	light pink	ID	AWG30 UL1005
227	light blue	IE	AWG30 UL1005
228	light green	IF	AWG30 UL1005
229	light yellow	IG	AWG30 UL1005
230	light orange	IH	AWG30 UL1005
231	light red	II	AWG30 UL1005
232	light pink	IJ	AWG30 UL1005
233	light blue	IK	AWG30 UL1005
234	light green	IL	AWG30 UL1005
235	light yellow	IM	AWG30 UL1005
236	light orange	IN	AWG30 UL1005
237	light red	IO	AWG30 UL1005
238	light pink	IP	AWG30 UL1005
239	light blue	IQ	AWG30 UL1005
240	light green	IR	AWG30 UL1005
241	light yellow	IS	AWG30 UL1005
242	light orange	IT	AWG30 UL1005
243	light red	IU	AWG30 UL1005
244	light pink	IV	AWG30 UL1005
245	light blue	IW	AWG30 UL1005
246	light green	IX	AWG30 UL1005
247	light yellow	IY	AWG30 UL1005
248	light orange	IZ	AWG30 UL1005
249	light red	JA	AWG30 UL1005
250	light pink	JB	AWG30 UL1005
251	light blue	JC	AWG30 UL1005
252	light green	JD	AWG30 UL1005
253	light yellow	JE	AWG30 UL1005
254	light orange	JF	AWG30 UL1005
255	light red	JG	AWG30 UL1005
256	light pink	JH	AWG30 UL1005
257	light blue	JI	AWG30 UL1005
258	light green	JI	AWG30 UL1005
259	light yellow	JK	AWG30 UL1005
260	light orange	JK	AWG30 UL1005
261	light red	JL	AWG30 UL1005
262	light pink	JL	AWG30 UL1005